

PUBLIC OPEN HOUSE MEETING – JUNE 24, 2003

**PERTAINING TO A
SITE DEVELOPMENT PLAN for
Part of SE 29; 39-2-W5 adjacent to Sylvan Lake**

Frank Layton, the owner of Plan 1411 MC in the SE 29; 39-2-W5, is proposing to develop 22 residential lots on a 11.8 ha parcel adjacent to the northwest corner of Sylvan Lake (see location map below). The parcels range from 0.3 to 0.4 ha in size.

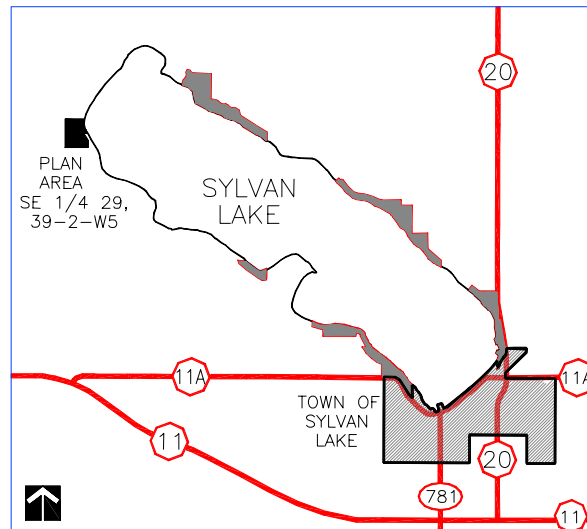

A public open house meeting is scheduled to provide the public an opportunity to view the preliminary development concept plan and to discuss aspects of the site development concept.

The public is invited to participate at the open house which will be held:

DATE: Tuesday, June 24, 2003
TIME: Between 2:00 p.m. and 4:00 p.m.
LOCATION: GreenWay Inn, 5401 HWY 2A, Lacombe, Alberta

For more information, contact:

Bill Shaw
Parkland Community Planning Services
Telephone: (403) 343-3394
Fax: (403) 346-1570
e-mail: bills@pcps.ab.ca

Carole Hunt
Bennett Jones LLP
Telephone: (780) 917-4292
Fax: (780) 421-7951
huntc@bennettjones.ca