

BYLAW NO. 1367/22

A BYLAW OF LACOMBE COUNTY, IN THE PROVINCE OF ALBERTA, TO AMEND THE LACOMBE COUNTY LAND USE BYLAW NO. 1237/17, AS IT RELATES TO DISTRICTING

WHEREAS notice was given of Council's intention to amend the Land Use Bylaw in the following local newspapers:

XX

AND WHEREAS a public hearing was held on XX, 2022 to allow the general public to comment on the proposed amendments to the Land Use Bylaw;

NOW THEREFORE the Council of Lacombe County under the authority and pursuant to the provisions of the *Municipal Government Act*, RSA 2000, c.M-26-1, as amended, enacts that the Land Use Bylaw be amended as follows:

approximately 3.65 hectares (9.04 acres) of land legally described as:

FIRST

ALL THAT PORTION OF THE NORTH WEST QUARTER OF SECTION THIRTY FOUR (34)
TOWNSHIP THIRTY NINE (39)
RANGE TWO (2)
WEST OF THE FIFTH MERIDIAN., WHICH IS NOT COVERED BY ANY OF THE WATERS OF SNAKE LAKE., AS SHOWN ON A PLAN OF SURVEY OF THE SAID TOWNSHIP SIGNED AT OTTAWA ON THE 3RD DAY OF SEPTEMBER., A.D. 1902, CONTAINING 51.8 HECTARES (128 ACRES) MORE OR LESS.
EXCEPTING THEREOUT HECTARES (ACRES) MORE OR LESS
ALL THAT PORTION DESCRIBED AS FOLLOWS: COMMENCING AT THE INTERSECTION OF THE WEST BOUNDARY OF THE SAID QUARTER SECTION WITH THE NORTH EASTERLY BANK OF SAID SNAKE LAKE; THENCE NORTHERLY ALONG SAID WEST BOUNDARY TO THE NORTH WEST CORNER OF THE SAID QUARTER SECTION; THENCE EASTERLY ALONG THE NORTH BOUNDARY OF SAID QUARTER SECTION, A DISTANCE OF SIX AND FIVE TENTHS (6.5) CHAINS; THENCE SOUTHERLY AND PARALLEL TO THE WEST BOUNDARY OF SAID QUARTER SECTION, TO THE NORTH EASTERLY BANK OF SNAKE LAKE AS SHOWN ON SAID PLAN OF SURVEY; THENCE NORTH WESTERLY ALONG SAID NORTH EASTERLY BANK OF SNAKE LAKE, TO THE POINT OF COMMENCEMENT 4.86 12.00
PLAN 0326192 ROAD 0.678 1.67
EXCEPTING THEREOUT ALL MINES AND MINERALS

SECOND

ALL THAT PORTION OF THE SOUTH WEST QUARTER OF SECTION THIRTY FOUR (34)
TOWNSHIP THIRTY NINE (39)

RANGE TWO (2)
WEST OF THE FIFTH MERIDIAN, WHICH IS NOT COVERED BY ANY OF THE
WATERS
OF SNAKE LAKE, AS SHOWN ON A PLAN OF SURVEY OF THE SAID
TOWNSHIP SIGNED
AT OTTAWA ON THE 3RD DAY OF SEPTEMBER, A.D. 1902, CONTAINING 17.0
HECTARES (42 ACRES) MORE OR LESS
EXCEPTING THEREOUT ALL MINES AND MINERALS

as outlined on the attached hereto and forming part of this Bylaw

be redesignated from Agricultural 'A' District to Residential Conservation Cluster 'R-RCC'
District.

This Bylaw shall come into effect upon final passage thereof.

INTRODUCED AND GIVEN FIRST READING this XX day of XX, 2022

GIVEN SECOND READING this XX day of XX, 2022

GIVEN THIRD AND FINAL READING this XX day of XX, 2022

Barb Shepherd
Reeve

Tim Timmons
County Manager

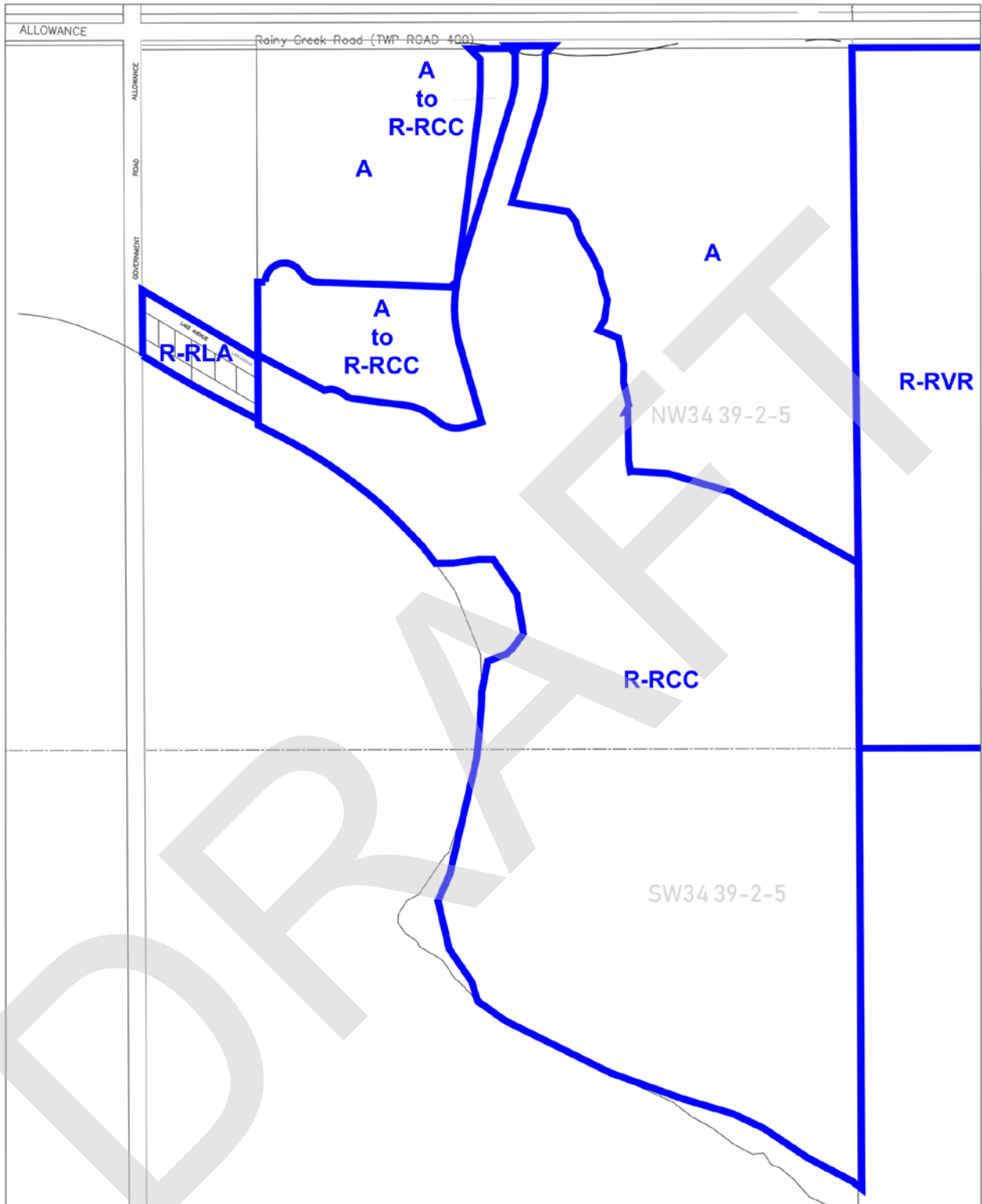

Redistricting Plan
Palm Cove Stage 1
February 15, 2022

— LAND USE DISTRICT BOUNDARY

NOTES:
THIS IS NOT A LEGAL PLAN AND MAY BE
SUBJECT TO ERRORS AND/OR OMISSIONS.

SHOWING PROPOSED REDISTRICTING OF PART OF
"NW34 39-2-5 and SW34 39-2-5"

Scale NTS

