

## Phase I Environmental Site Assessment

Block 8, Plan 982 4271  
Lacombe County, Alberta

Presented to

Jacqueline Penn  
A.D. Williams Engineering Ltd.



### REVISION INDEX

ECOMARK Project No.: ADWIL-08105-00-0					
B	July 11, 2008	Issue for Review	PW		PW
A	June 20, 2008	Issue for Review	JMB	PW, DL	PW
Rev	Date	Description	Prepared	Checked	Approved

## LETTER OF TRANSMITTAL

July 11, 2008

Our Project Number: ADWIL-08105-00-0

Ms. Jacqueline Penn  
A.D. Williams Engineering Ltd.  
#210, 7240 Johnstone Drive  
Red Deer, AB T4P 3Y6

Dear Ms. Penn:

**Re: Phase I Environmental Site Assessment  
Block 8, Plan 982 4271  
Lacombe County, Alberta**

We are pleased to present the above-referenced phase I environmental site assessment report (Report) for you and your financial institution's benefit and use in assessing the environmental integrity of the property known as Block 8, Plan 982 4271, Lacombe County, Alberta.

This Report is based on a visual, non-destructive inspection of the subject property and neighbouring properties, historical document searches, interviews and an air photo review and is supplemented by searches for environmental protection orders, an underground storage tank survey, a water well search and an Abacus Datagraphics Ltd. record search. This Report conforms to the Canadian Standards Association (CSA) Phase I Environmental Assessment criteria outlined in the CSA document Z768-01 (Reaffirmed 2006).

The opinions expressed in this Report are solely those of Ecomark Ltd. This Report is furnished in our capacity as consultants to A.D. Williams Engineering Ltd. (Client) for the project described in this Report and does not necessarily reflect the viewpoint of the Client. The Report is written for the benefit and use of the Client and their financial institution only. Conditions assessed are valid to the date of visual assessment and limited by the information that was shared by the third parties involved. This Report shall be valid for one month following the date of the Report. While every effort was made to confirm that the data collected from third parties is factual, complete and accurate, Ecomark Ltd. makes no guarantees or warranties whatsoever with respect to such data. Financial liability is limited to the invoiced amount of the report.

Requests for additional copies of this Report and revised letters of transmittal for institutions other than the originally named institution subsequent to the date of the Report shall be subject to additional fees.

Yours sincerely,

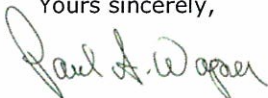

**Paul A. Wagner, M.Sc., P.Geol.**



**Professional Seal**



**Jeannie Marie Blanchard, B.A.**

## TABLE OF CONTENTS

<b>EXECUTIVE SUMMARY .....</b>	<b>1</b>
<b>1 SCOPE OF WORK.....</b>	<b>2</b>
<b>2 RECORDS REVIEW .....</b>	<b>2</b>
2.1 HISTORICAL LAND TITLES .....	2
2.2 HISTORICAL AIR PHOTOS .....	3
2.3 PROPERTY USE RECORDS .....	5
2.4 MUNICIPALITY RECORDS .....	5
2.5 ENVIRONMENTAL PROTECTION ORDERS .....	5
2.6 PETROLEUM TANK MANAGEMENT ASSOCIATION OF ALBERTA .....	5
2.7 WATER WELL SURVEY .....	5
2.8 ABADATA RECORD SEARCH .....	6
2.9 PAST ENVIRONMENTAL REPORTS .....	7
<b>3 SITE ASSESSMENT .....</b>	<b>7</b>
3.1 PHYSICAL SETTING .....	7
3.2 LIMITATIONS .....	8
3.3 PROPERTY USE .....	8
3.4 HAZARDOUS MATERIALS .....	8
3.5 UNIDENTIFIED SUBSTANCES .....	9
3.6 STORAGE TANKS .....	9
3.7 STORAGE CONTAINERS .....	9
3.8 ODOURS .....	9
3.9 POTABLE WATER SUPPLY .....	9
3.10 BUILDINGS .....	9
3.11 EXTERIOR OBSERVATIONS .....	9
3.11.1 General .....	9
3.11.2 Neighbouring Properties .....	9
3.11.3 Topographic, Geologic, and Hydrogeologic Conditions .....	9
3.11.4 General Description of Structures .....	10
3.11.5 Wells .....	10
3.11.6 Sewage Disposal .....	10
3.11.7 Pits and Lagoons .....	10
3.11.8 Stained Materials .....	10
3.11.9 Stressed Vegetation .....	10
3.11.10 Fill .....	10
3.11.11 Watercourses, Ditches, or Standing Water .....	10
3.11.12 Roads, Parking Facilities, and Rights-of-Way .....	10
<b>4 INTERVIEWS .....</b>	<b>10</b>
<b>5 EVALUATION OF INFORMATION .....</b>	<b>10</b>
<b>6 RECOMMENDATIONS .....</b>	<b>11</b>
<b>7 REFERENCES .....</b>	<b>12</b>



## LIST OF FIGURES

Figure 1: Site drawing. ....	13
Figure 2: Map of area (Google Maps, 2008). ....	14
Figure 3: Air photo (AS 5408, Photo #174). ....	14
Figure 4: Scrap metal and metal covered with ceramic. ....	15
Figure 5: A shoe. ....	15
Figure 6: Scrap lumber and shingles. ....	16
Figure 7: Burned vegetation. ....	16
Figure 8: Marsh area. ....	17
Figure 9: Area of standing water. ....	17

## APPENDICES

Appendix 1: Land Title Survey	
Appendix 2: Environmental Protection Search	
Appendix 3: Petroleum Tank Survey	
Appendix 4: Water Well Survey	
Appendix 5: AbaData Record Search	
Appendix 6: Disclosure Statements	
Appendix 7: Past Environmental Reports	
Appendix 8: Qualifications and Information Pertaining to the Environmental Consultants	



## EXECUTIVE SUMMARY

At the request of Jacqueline Penn of A.D. Williams Engineering Ltd., Ecomark Ltd. was retained to perform a phase I environmental site assessment of the property known as Block 8, Plan 982 4271, Lacombe County, Alberta. Historical land titles (Appendix 1), historical documents, an interview (Appendix 6), air photo reviews, onsite inspections and inspections of nearby properties were supplemented by searches for environmental protection orders (Appendix 2), an underground storage tank survey (Appendix 3), a water well survey (Appendix 4) and an Abacus Datagraphics Ltd. record search (Appendix 5).

Findings and recommendations are found in section 6 of this phase I environmental site assessment report (Report).

The opinions expressed in this Report are solely those of Ecomark Ltd. This Report is furnished in our capacity as consultants to A.D. Williams Engineering Ltd. (Client) for the project described in this Report and do not necessarily reflect the viewpoint of the Client. The Report is written for the benefit and use of the Client only and may only be relied upon by the Client in connection with the phase I environmental site assessment. Conditions assessed are valid to the date of visual assessment and limited by the information that was shared by the third parties involved. While every effort is made to confirm that the data collected from third parties is factual, complete and accurate, Ecomark Ltd. makes no guarantees or warranties whatsoever with respect to such data. Financial liability is limited to the invoiced amount of the report.

# 1 SCOPE OF WORK

At the request of Jacqueline Penn of A.D. Williams Engineering Ltd., Ecomark Ltd. was retained to perform a phase I environmental site assessment of the property known as Block 8, Plan 982 4271, Lacombe County, Alberta. This assessment contains a records review, which includes:

- a) Historical land titles (Section 2.1 and Appendix 1);
- b) Historical air photos (Section 2.2 and Figure 2);
- c) Municipal records (Section 2.3 and 2.4, and Appendix 2);
- d) Environmental Law Centre records about enforcement actions (Section 2.5 and Appendix 2);
- e) Inventories of underground and aboveground storage tanks (Petroleum Tank Management Association of Alberta) (Section 2.6 and Appendix 3);
- f) Well logs or water well databases (Alberta Environment Groundwater System) (Section 2.7 and Appendix 4); and
- g) An Abacus Datagraphics Ltd. record search (Section 2.8 and Appendix 5).

This assessment also includes a site visit, interviews and an evaluation of information and reporting. The subject property was inspected on June 16, 2008.

## 2 RECORDS REVIEW

### 2.1 Historical Land Titles

Historical land titles were reviewed and are summarized in the following table. For more detail, see Appendix 1.

**Table 2.1 Land Title Review**

**Block 8, Plan 982 4271**

Date Range	Land Owner
2006 – Present	Frank Wilson
1998 – 2006	Sandy Point Farms Ltd.

**Block 1, Plan 792 1404 (Title cancelled and reissued as Plan 982 4269)**

Date Range	Land Owner
1998	Sandy Point Farms Ltd.

**Blocks 1 & 3, Plan 792 1404**

Date Range	Land Owner
1979 - 1998	Sandy Point Farms Ltd.

## 2.2 Historical Air Photos

Air photos from 1949 to 2007 were observed.

- **22-Sep-1949 AS 150 #165 (1:40,000)**

**Subject Property:** The subject property was predominately shoreline and cultivated agricultural land. There was a forested area at the western portion of the subject property and a forested ridge along the central portion of the subject property. Immediately east of the forested ridge, there was a floodplain with no visible vegetation.

**Surrounding Properties:** Gull Lake was located immediately east of the subject property. The surrounding properties were predominately agricultural and forested land. There is a large wetland in the quarter section northwest of the subject property.

- **30-Jun-1962 AS 822 #44 (1:31,680)**

**Subject Property:** There was an access road along the southwestern portion of the subject property to several unidentified structures or buildings at the northwestern portion of the subject property. A portion of the forested area at the western portion of the subject property was removed. Shrubbery was establishing immediately east of the forested ridge within the floodplain.

**Surrounding Properties:** There was a farmyard immediately northwest of the subject property. There were several low-lying wet areas and ephemeral drainages on surrounding properties.

- **22-Aug-1966 AS 949 #189 (1:31,680)**

**Subject Property:** There were no significant changes to the subject property.

**Surrounding Properties:** There were some unidentified structures in the cultivated agricultural land immediately southwest of the subject property. There were no other significant changes.

- **13-May-1969 AS 1014 #81 (1:31,680)**

**Subject Property:** There were several game trails throughout the floodplain immediately east of the forested ridge. There were no other significant changes.

**Surrounding Properties:** There were no significant changes to the surrounding properties.



- **11-Aug-1975 AS 1440 #65 (1:31,680)**

**Subject Property:** More shrubbery was growing immediately east of the forested ridge. There were no other significant changes.

**Surrounding Properties:** There were no significant changes to the surrounding properties.

- **24-Apr-1980 AS 2157 #194 (1:60,000)**

**Subject Property:** There were no significant changes to the subject property.

**Surrounding Properties:** There were no significant changes to the surrounding properties.

- **22-Apr-1983 AS 2695 #206 (1:30,000)**

**Subject Property:** There were no significant changes to the subject property.

**Surrounding Properties:** There was ice cover on Gull Lake. There were no other significant changes.

- **12-Jul-1987 AS 3610 #247 (1:30,000)**

**Subject Property:** More shrubbery was growing immediately east of the forested ridge. There were no other significant changes.

**Surrounding Properties:** There were no significant changes to the surrounding properties.

- **4-Jun-1993 AS 4416 #171 (1:30,000)**

**Subject Property:** There were no significant changes to the subject property.

**Surrounding Properties:** There was a lease site on the property south of the subject property.

- **13-May-1998 AS 4971 #15 (1:30,000)**

**Subject Property:** The unidentified structures or buildings were removed from the northwestern portion of the subject property.

**Surrounding Properties:** The lease site south of the subject property was reclaimed.

- **31-May-2007 AS 5408 #174 (1:40,000)**

**Subject Property:** There were no significant changes to the subject property.

**Surrounding Properties:** There was a large lease site and access road immediately west of the subject property. There was a large dugout at the same location as the former lease site south of the subject property.

## **2.3 Property Use Records**

The subject property is zoned as Agricultural "A" land use by Lacombe County.

## **2.4 Municipality Records**

Lacombe County was requested to report on any records of emergency response, landfills, property infractions, sewers use bylaw infractions and reduced property tax assessments due to soil degradation. They reported no bylaw investigations, tickets or prosecutions of any environmentally related events, as well as no record of landfills, waste sites, nuisance grounds or environmental incidents (Appendix 2).

## **2.5 Environmental Protection Orders**

The Environmental Law Center was searched for matches to the following names: Frank Wilson and Sandy Point Farms Ltd. They reported no enforcement actions issued under the Alberta *Environmental Protection and Enhancement Act* (EPEA) or its predecessor legislation (Appendix 2)

The Environmental Law Center was also requested to perform a wellsite reclamation historical search for the property known as the south half of 12-41-1-W5M, the quarter sections containing the subject property. They reported no reclamation certificates issued for these quarter sections.

## **2.6 Petroleum Tank Management Association of Alberta**

The Petroleum Tank Management Association of Alberta (PTMAA) was requested to report on any tanks at the south half of 12-41-1-W5M, the quarter sections containing the subject property. They reported that no active or abandoned storage tanks exist on the subject property (Appendix 3).

## **2.7 Water Well Survey**

The Alberta Environment groundwater information system was searched for records of water wells on the subject property. According to Alberta Environment, there were three water wells registered on the section containing the subject property. It was unknown whether any of these wells were located on the subject property. These wells were used for industrial, stock and domestic water uses. Details of these wells can be found in Table 2.2 below and in Appendix 4.

There were eight water wells registered in the adjoining sections. These wells were used for unknown, domestic, and stock water uses. Details of these wells can be found in Table 2.3 below and in Appendix 4.

**Table 2.2 Water Wells on the Section Containing the Subject Property**

Well ID	Depth in Meters	Non-pumping Static level in Meters	Lithology Description
0435954	17.37	6.1	N/A
0435955	48.77	N/A	Sand and till over yellow clay and shale, greenish yellow shale, sand and till, gray shale, gray shale and rocks, gray sand, gray shale, gray sand, blue gray shale, light gray shale, brownish gray shale, and gray sand.
0497115	48.77	12.8	Clay over gray shale, green shale, gray shale, and gray sandstone.

**Table 2.3 Water Wells on Surrounding Properties**

Well ID	Depth in Meters	Non-pumping Static level in Meters	Lithology Description
0341921	56.86	6.71	Clay over brown shale, brown sandstone, and varying layers of gray sandstone and gray shale.
0341922	54.86	7.32	Brown clay over brown sandstone, brown shale, and varying layers of gray shale and gray sandstone.
0341923	27.43	7.01	Brown clay over brown sandstone, brown shale, brownish green sandstone, brownish green fractured shale, gray shale, gray hard sandstone, and varying layers of gray shale and gray sandstone.
0354465	38.1	N/A	N/A
0435633	329.18	N/A	N/A
0435956	15.24	N/A	N/A
0435957	15.24	N/A	N/A
0478956	36.58	4.57	N/A
0497115	48.77	12.8	Clay over gray shale, green shale, gray shale, and gray sandstone.
0435955	48.77	N/A	Sand and till over yellow clay and shale, greenish yellow shale, sand and till, gray shale, gray shale and rocks, gray sand, gray shale, gray sand, blue gray shale, light gray sand, brownish gray shale, and gray sand.

## 2.8 AbaData Record Search

Abacus Datagraphics Ltd. provides a web-based, oilfield-mapping program (AbaData) that uses current information to graphically display the location of oilfield facilities within Alberta and provides information about



these facilities. The sources of this information include the Energy Resources Conservation Board (ERCB), Alberta Energy, Alberta Environment and AltaLIS.

AbaData reported one pipeline, four wells, no spills/complaints and no facilities located on the quarter sections containing the subject property, none of which appear to be on the subject property. One of the directionally drilled wells, however, does run through the subject property. Pipeline 24658-10 was an operating, natural gas pipeline licensed to Provident Energy Ltd. on April 20, 2001. Details of the wells can be found in Table 2.4 below and in Appendix 5.

On the quarter sections surrounding the subject property there was one pipeline, three wells, no spills/complaints and no facilities. Pipeline 24658-10 from the subject property, also ran through the surrounding properties. Details of the wells can be found in Table 2.5 below and in Appendix 5.

**Table 2.4 Wells on the Section Containing the Subject Property**

Well ID	Licensee	License Date	Well Type	Status
00/15-08-041-28 W4/2	Cabrerra Resources Ltd.	July 27, 2006	N/A	Commingle
W0/13-01-041-01 W5/0	Chevron Canada Limited	September 2, 1953	N/A	Abandoned (September 3, 1953)
00/14-01-041-01 W5/3	Progress Energy Ltd.	August 23, 2000	N/A	Flowing Gas
00/06-12-041-01 W5/0	Provident Energy Ltd.	August 16, 2000	N/A	Flowing Gas

**Table 2.5 Wells on the Surrounding Properties**

Well ID	Licensee	License Date	Well Type	Status
00/15-08-041-28 W4/2	Cabrerra Resources Ltd.	July 27, 2006	N/A	Commingle
W0/13-01-041-01 W5/0	Chevron Canada Limited	September 2, 1953	N/A	Abandoned (September 3, 1953)
00/14-01-041-01 W5/3	Progress Energy Ltd.	August 23, 2000	N/A	Flowing Gas

## **2.9 Past Environmental Reports**

A phase I environmental site assessment was performed on the subject property in 2003. However, Ecomark Ltd. did not have access to this report.

## **3 SITE ASSESSMENT**

### **3.1 Physical Setting**

The subject property is located in the Dry Mixedwood Natural Subregion of Alberta.

The Dry Mixedwood Natural Subregion is the second largest subregion of Alberta. Elevations range from 200 m to 1225 m. Level to gently undulating glacial till or lacustrine plains are characteristic of this region (ANHIC, 2006).

Vegetation in the Dry Mixedwood Natural Subregion is characterized by aspen forests and cultivated landscapes (ANHIC, 2006).

Soils in this region are predominantly Gray Luvisols with Dark Gray Chernozems and Luvisols, Organics, Gleysols, Dystric Brunisols, Eutric Brunisols and trace amounts of Regosols (ANHIC, 2006).

The Dry Mixedwood Natural Subregion has a mean annual temperature of 1.1 degrees Celsius, with a mean daily maximum temperature of 22.4 degrees Celsius and a mean daily minimum temperature of -22.3 degrees Celsius. The frost-free period is 98 days. The mean annual precipitation of this subregion is 460.6 mm, with a growing season (April to August) mean precipitation of 324.2 mm (ANHIC, 2006).

### **3.2 Limitations**

The entire property was visible and Ecomark Ltd. had access to most of the subject property. Some areas of the subject property had water that impeded Ecomark Ltd.'s access.

### **3.3 Property Use**

The subject property was located at Block 8, Plan 982 4271, Lacombe County, Alberta. The total area of the site was 70.397 ha. The subject property was agricultural and forested land.

### **3.4 Hazardous Materials**

There is no visible evidence of the following environmental hazards:

- Outside or inside transformers containing polychlorinated biphenyls (PCBs)
- Urea formaldehyde
- Perchloroethylene
- Mercury
- Air pollution
- Incineration
- Lead-based paints
- Lead piping
- Treated wood
- Ozone depleting materials
- Chronic contamination
- Biological hazards
- Waste water
- Chlorofluorocarbons
- Stressed vegetation
- Radon and methane gas
- Radioactive materials and equipment
- Asbestos-containing materials (ACMs)
- Evidence of past pollution

- Disposal of waste
- Mould or indications of mould (water damage)
- Acids and/or other chemicals
- Hydrocarbons

There is evidence of the following constituents of concern:

- Pesticides or herbicides (Section 3.11.9)

### **3.5 Unidentified Substances**

No unidentified substances were found on the subject property during the course of the site inspection.

### **3.6 Storage Tanks**

No storage tanks were found on the subject property during the course of the site inspection.

### **3.7 Storage Containers**

No storage containers were found on the subject property during the course of the site inspection.

### **3.8 Odours**

No odours were detected on the subject property at the time of inspection.

### **3.9 Potable Water Supply**

No potable water supply was found on the subject property during the course of the site inspection.

### **3.10 Buildings**

No buildings were found on the subject property at the time of inspection.

### **3.11 Exterior Observations**

#### **3.11.1 General**

Scrap metal and metal coated with ceramic was found on the subject property as was a shoe, scrap lumber and shingles (Figures 4-6).

#### **3.11.2 Neighbouring Properties**

- Directly west of the property: Agricultural land and a lease area.
- Directly east of the property: Gull Lake and a lease area.
- Directly south of the property: Forested and agricultural land.
- Directly north of the property: Forested land.

#### **3.11.3 Topographic, Geologic, and Hydrogeologic Conditions**

The subject property was hilly and sloped to the east.



#### 3.11.4 General Description of Structures

No structures were found on the subject property during the course of the site inspection.

#### 3.11.5 Wells

No wells were found on the subject property during the course of the site inspection.

#### 3.11.6 Sewage Disposal

No connection to a sewage disposal system was found during the course of the site inspection.

#### 3.11.7 Pits and Lagoons

No pits or lagoons were found on the subject property during the course of the site inspection.

#### 3.11.8 Stained Materials

No stained materials were found on the subject property during the course of the site inspection.

#### 3.11.9 Stressed Vegetation

Some burned vegetation was found near the cultivated area of the subject property (Figure 7). It appeared to be due to excess use of agricultural products.

#### 3.11.10 Fill

No fill was found on the subject property during the course of the site inspection.

#### 3.11.11 Watercourses, Ditches, or Standing Water

There was a marsh, approximately 100-200 meters width along the east border of the subject property bordering Gull Lake. Areas of standing water, possibly due to the ground being saturated, were found near and on the quad trails.

#### 3.11.12 Roads, Parking Facilities, and Rights-of-Way

No roads, parking facilities or rights-of-way were found on the subject property during the course of the site inspection.

## 4 INTERVIEWS

The property owner declined to complete the environmental questionnaire.

## 5 EVALUATION OF INFORMATION

The subject property was 70.397 ha of land located at Block 8, Plan 982 4271, Lacombe County, Alberta. It was zoned Agricultural "A" land use by Lacombe County.

A review of historical air photos indicated that the subject property was agricultural land with some treed areas in the 1949 photograph. In the 1962 photograph there were several buildings located in the northwestern portion of the subject property, which were removed by the 1998 photograph.

Lacombe County reported no records for the subject property pertaining to items of environmental concern.

The Environmental Law Center reported no enforcement actions against Frank Wilson or Sandy Point Farms Ltd.

According to the Petroleum Tank Management Association of Alberta, there were no aboveground or underground storage tanks located on the subject property.

A search of Alberta Environment's groundwater information system revealed three water wells located on the section containing the subject property. These wells were used for industrial, stock and unknown water uses.

AbaData reported no pipelines, wells, spills/complaints or facilities on the subject property.

A site inspection showed the subject property to be predominantly agricultural land with some treed areas and marsh. Some burned vegetation was found on the subject property. No hazardous materials, storage tanks, or staining were found on the subject property.

## **6 RECOMMENDATIONS**

A.D. Williams Engineering Ltd. should be aware that a directionally drilled well runs through the subject property. Any releases that may occur from this well are the responsibility of the licensee, Provident Energy Ltd.

Based on our findings of the review of documents pertaining to the subject property and a site inspection, the greatest potential environmental liability is associated with the operating gas well located immediately west of the subject property. All contamination associated with the well is the responsibility of the licensee, Provident Energy Ltd.

Nonetheless, it is recommended that a phase II environmental site assessment be conducted along the subject property boundary to determine if any hydrocarbon, salt or metal contamination has migrated on to the subject property.

## 7 REFERENCES

Abacus Datagraphics Ltd. Accessed June 12 and 17, 2008 [www.abacusdatagraphics.com](http://www.abacusdatagraphics.com)

Alberta Environment Groundwater Information System. Accessed June 12 and 17, 2008.  
[http://www.telusgeomatics.com/tgpub/ag\\_water/](http://www.telusgeomatics.com/tgpub/ag_water/)

Alberta Natural Heritage Information Centre (ANHIC). 2006. Natural Regions and Subregions of Alberta.

Alberta Registries. June 12, 2008. Historical Land Title for the subject property.

Alberta Sustainable Resource Development. 2007. Air photo AS5408 #174.

Lacombe County. June 11, 2008. Letter response on the subject of property infractions.

Environmental Law Centre. June 13, 2008. Searches for enforcement actions.

Environmental Law Centre. June 9, 2008. Searches for reclamation certificates.

Google Maps. Accessed June 18, 2008. <http://www.maps.google.ca>.

Petroleum Tank Management Association of Alberta. June 9, 2008. Tank report.



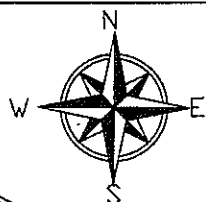
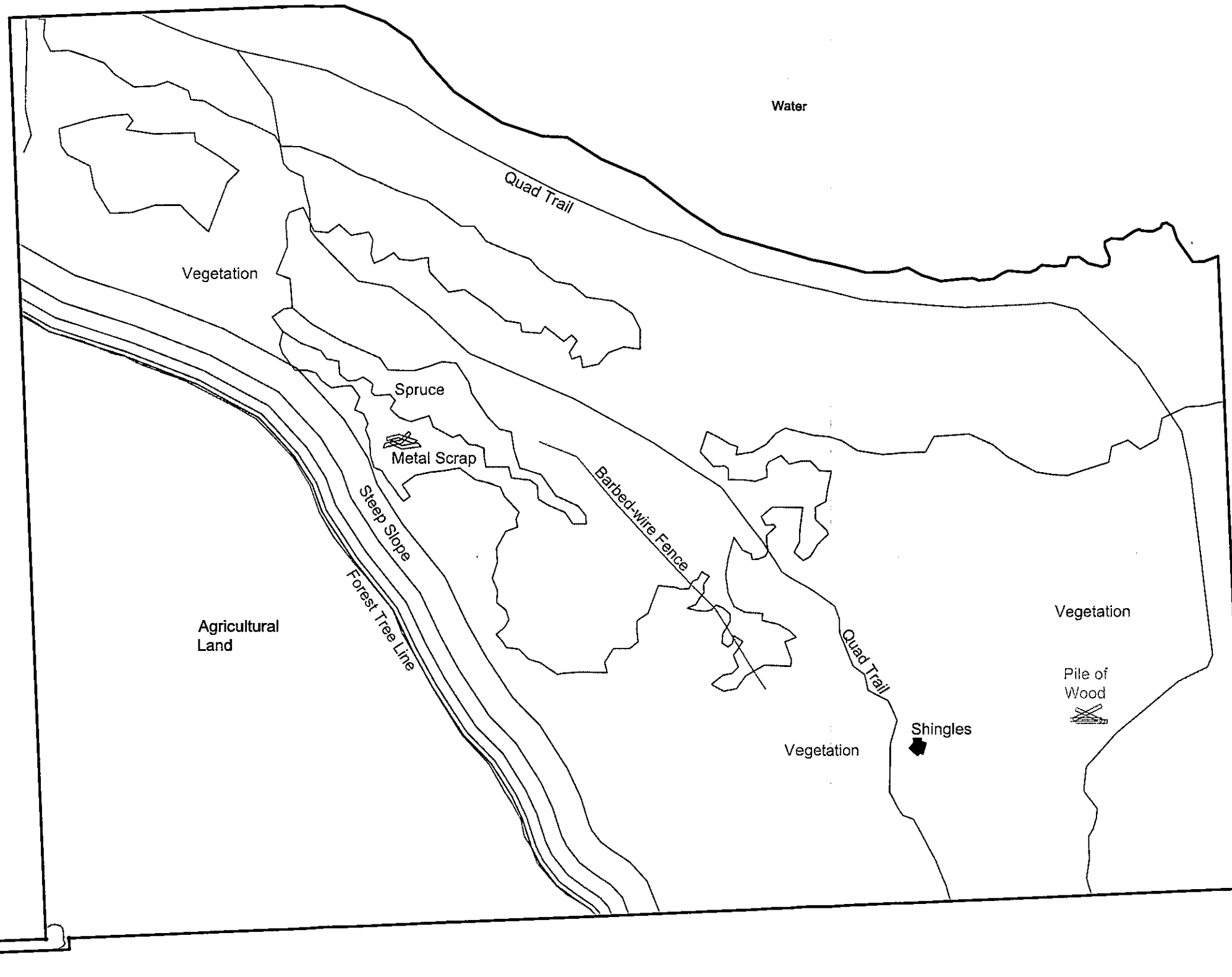

REV #	DATE	DESCRIPTION
1.0	2008-06-19	DRAFT FOR REVIEW

**SITE SKETCH**  
Block 8, Plan 982 4271  
Lacombe County, AB

DRAWN BY:  
HY  
REVIEWED BY:  
JMB  
APPROVED BY:  
JMB

**ECOMARK**  
PROJECT: ADWIL-08105-00-0  
DATE: 2008-06-19  
DWG NAME: ADWIL-0810x-00-0\_SK1\_d-hy-1

REV 1.0  
FIG 1

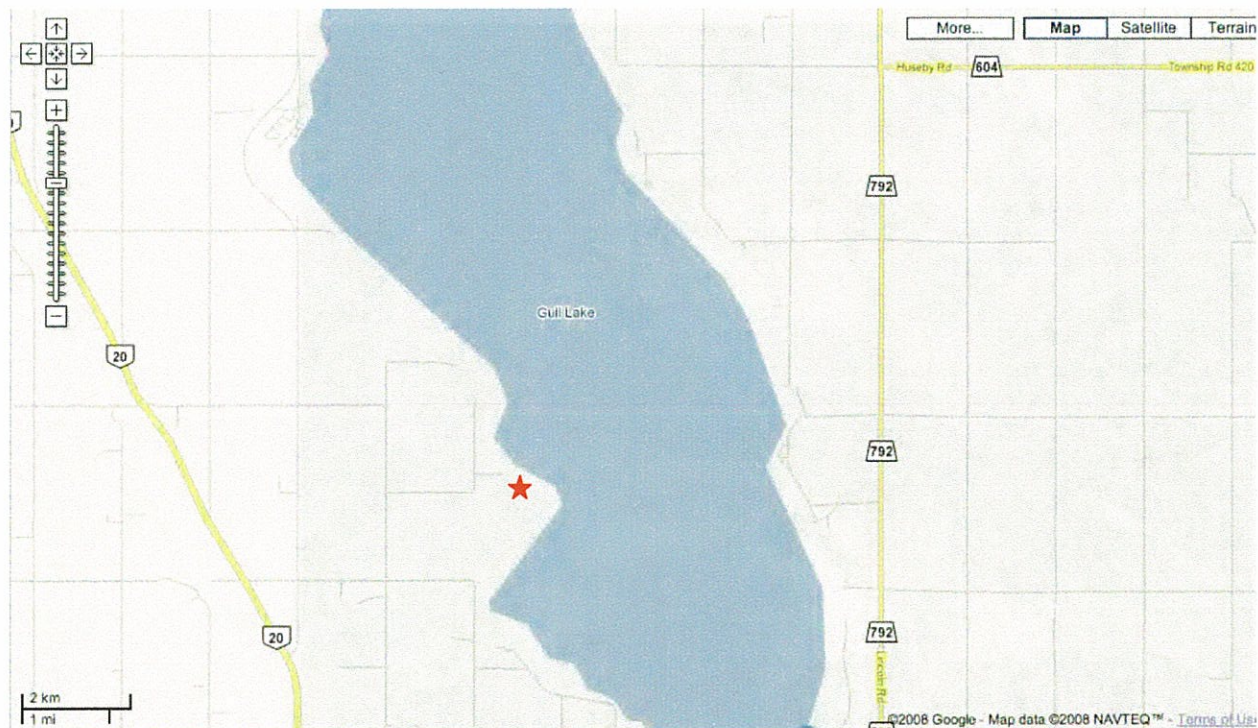

**Figure 2: Map of area (Google Maps, 2008).**



**Figure 3: Air photo (AS 5408, Photo #174).**





**Figure 4: Scrap metal and metal covered with ceramic.**



**Figure 5: A shoe.**





**Figure 6: Scrap lumber and shingles.**



**Figure 7: Burned vegetation.**





**Figure 8: Marsh area.**



**Figure 9: Area of standing water.**

## Appendix 1: Land Title Survey





HISTORICAL LAND TITLE CERTIFICATE  
CURRENT TITLE WITH HISTORICAL DATA

S  
LINC                      SHORT LEGAL                      TITLE NUMBER  
0027 602 390            9824271;8            062 247 958 +3

LEGAL DESCRIPTION

DESCRIPTIVE PLAN 9824271  
BLOCK 8  
EXCEPTING THEREOUT ALL MINES AND MINERALS  
AREA: 70.397 HECTARES (173.95 ACRES) MORE OR LESS

ATS REFERENCE: 5;1;41;1;NW  
ATS REFERENCE: 5;1;41;12;S  
ESTATE: FEE SIMPLE

MUNICIPALITY: LACOMBE COUNTY

REFERENCE NUMBER: 982 263 209

REGISTERED OWNER(S)				
REGISTRATION	DATE(DMY)	DOCUMENT TYPE	VALUE	CONSIDERATION
062 247 958	12/06/2006	TRANSFER OF LAND		CASH TO MORTGAGE

OWNERS

FRANK WILSON  
OF 8-10ST  
SYLVAN LAKE  
ALBERTA T4S 2P3

ENCUMBRANCES, LIENS & INTERESTS

REGISTRATION	DATE (D/M/Y)	PARTICULARS
NUMBER		
062 247 959	12/06/2006	MORTGAGE MORTGAGEE - CANADIAN WESTERN BANK. 4822-51 AVE RED DEER

( CONTINUED )

-----  
ENCUMBRANCES, LIENS & INTERESTS

PAGE 2  
# 062 247 958 +3

REGISTRATION  
NUMBER DATE (D/M/Y) PARTICULARS  
-----

ALBERTA T4N4H3  
ORIGINAL PRINCIPAL AMOUNT: \$2,600,000

062 247 960 12/06/2006 CAVEAT  
RE : ASSIGNMENT OF RENTS AND LEASES  
CAVEATOR - CANADIAN WESTERN BANK.  
4822 SLAVE  
RED DEER  
ALBERTA  
AGENT - DONALD J SINCLAIR.

TOTAL INSTRUMENTS: 002

THE REGISTRAR OF TITLES CERTIFIES THIS TO BE AN ACCURATE  
REPRODUCTION OF THE CERTIFICATE OF TITLE REPRESENTED  
HEREIN THIS 12 DAY OF JUNE, 2008 AT 08:09 A.M.

ORDER NUMBER:11528577

CUSTOMER FILE NUMBER: 6866333

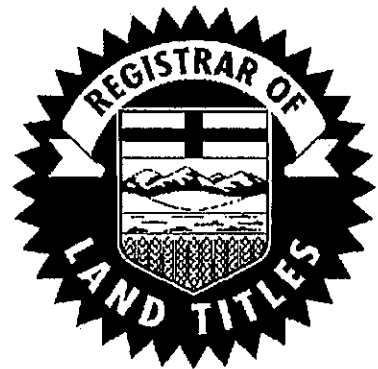

\*END OF CERTIFICATE\*

-----  
THIS ELECTRONICALLY TRANSMITTED LAND TITLES PRODUCT IS INTENDED FOR THE  
SOLE USE OF THE ORIGINAL PURCHASER, AND NONE OTHER, SUBJECT TO WHAT IS  
SET OUT IN THE PARAGRAPH BELOW.

THE ABOVE PROVISIONS DO NOT PROHIBIT THE ORIGINAL PURCHASER FROM  
INCLUDING THIS UNMODIFIED PRODUCT IN ANY REPORT, OPINION, APPRAISAL OR  
OTHER ADVICE PREPARED BY THE ORIGINAL PURCHASER AS PART OF THE ORIGINAL  
PURCHASER APPLYING PROFESSIONAL, CONSULTING OR TECHNICAL EXPERTISE FOR  
THE BENEFIT OF CLIENT(S).



HISTORICAL LAND TITLE CERTIFICATE

TITLE CANCELLED ON JUNE 12, 2006

S  
LINC 0027 602 390      SHORT LEGAL 9824271;8      TITLE NUMBER 982 263 209

LEGAL DESCRIPTION

DESCRIPTIVE PLAN 9824271  
BLOCK 8  
EXCEPTING THEREOUT ALL MINES AND MINERALS  
AREA: 70.397 HECTARES (173.95 ACRES) MORE OR LESS

ATS REFERENCE: 5;1;41;1;NW  
ATS REFERENCE: 5;1;41;12;S  
ESTATE: FEE SIMPLE

MUNICIPALITY: LACOMBE COUNTY

REFERENCE NUMBER: 982 263 107 +1  
982 263 029

-----  
REGISTERED OWNER(S)  
REGISTRATION      DATE(DMY)      DOCUMENT TYPE      VALUE      CONSIDERATION  
-----

982 263 209      01/09/1998      DESCRIPTIVE PLAN

OWNERS

SANDY POINT FARMS LTD.  
OF BOX 119  
BENTLEY  
ALBERTA T0C 0J0

(DATA UPDATED BY: CHANGE OF ADDRESS 052404536)

( CONTINUED )



-----  
ENCUMBRANCES, LIENS & INTERESTS

PAGE 2  
# 982 263 209

REGISTRATION

NUMBER DATE (D/M/Y) PARTICULARS

-----  
982 263 212 01/09/1998 REQUEST FOR RELEASE OF D.C.T.  
DCT ISSUED  
SURRENDERED BY 062247958  
  
052 404 536 21/09/2005 CHANGE OF ADDRESS FOR SERVICE  
RE: SANDY POINT FARMS LTD.  
BOX 119  
BENTLEY  
ALBERTA T0C0J0  
AFFECTS INSTRUMENT: 982263209  
  
062 247 958 12/06/2006 TRANSFER OF LAND  
OWNERS - FRANK WILSON  
8-10ST  
SYLVAN LAKE  
ALBERTA T4S2P3  
NEW TITLE ISSUED

TOTAL INSTRUMENTS: 003

THE REGISTRAR OF TITLES CERTIFIES THIS TO BE AN ACCURATE  
REPRODUCTION OF THE CERTIFICATE OF TITLE REPRESENTED  
HEREIN THIS 12 DAY OF JUNE, 2008 AT 08:09 A.M.

ORDER NUMBER:11528577

CUSTOMER FILE NUMBER: 6866333

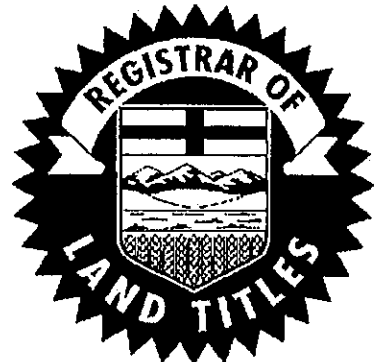

\*END OF CERTIFICATE\*

THIS ELECTRONICALLY TRANSMITTED LAND TITLES PRODUCT IS INTENDED FOR THE  
SOLE USE OF THE ORIGINAL PURCHASER, AND NONE OTHER, SUBJECT TO WHAT IS  
SET OUT IN THE PARAGRAPH BELOW.

THE ABOVE PROVISIONS DO NOT PROHIBIT THE ORIGINAL PURCHASER FROM  
INCLUDING THIS UNMODIFIED PRODUCT IN ANY REPORT, OPINION, APPRAISAL OR  
OTHER ADVICE PREPARED BY THE ORIGINAL PURCHASER AS PART OF THE ORIGINAL  
PURCHASER APPLYING PROFESSIONAL, CONSULTING OR TECHNICAL EXPERTISE FOR  
THE BENEFIT OF CLIENT(S).



HISTORICAL LAND TITLE CERTIFICATE  
TITLE CANCELLED ON SEPTEMBER 01,1998

S  
LINC                      SHORT LEGAL                      TITLE NUMBER  
0012 739 769              7921404;1              982 263 107 +1

LEGAL DESCRIPTION

PLAN 7921404  
BLOCK ONE (1)  
CONTAINING 69.8 HECTARES (172.50 ACRES) MORE OR LESS.  
EXCEPTING THEREOUT ALL MINES AND MINERALS

ATS REFERENCE: 5;1;41;12;S  
ESTATE: FEE SIMPLE

MUNICIPALITY: LACOMBE COUNTY

REFERENCE NUMBER: 982 263 029 +4

-----  
REGISTERED OWNER(S)  
REGISTRATION      DATE(DMY)      DOCUMENT TYPE      VALUE      CONSIDERATION  
-----

982 263 107      01/09/1998      DESCRIPTIVE PLAN

OWNERS

SANDY POINT FARMS LTD.  
OF #800, 335-8 AVENUE SW, CALGARY  
ALBERTA

-----  
ENCUMBRANCES, LIENS & INTERESTS

REGISTRATION  
NUMBER      DATE (D/M/Y)      PARTICULARS  
-----

982 263 209      01/09/1998      DESCRIPTIVE PLAN  
AFFECTED LAND:      7921404;1 CANCELLED IN FULL  
TITLE CANCELLED IN FULL

( CONTINUED )

-----  
ENCUMBRANCES, LIENS & INTERESTS

PAGE 2  
# 982 263 107 +1

REGISTRATION NUMBER	DATE (D/M/Y)	PARTICULARS
------------------------	--------------	-------------

-----

AFFECTED PLAN: 9824271

TOTAL INSTRUMENTS: 001

THE REGISTRAR OF TITLES CERTIFIES THIS TO BE AN ACCURATE  
REPRODUCTION OF THE CERTIFICATE OF TITLE REPRESENTED  
HEREIN THIS 12 DAY OF JUNE, 2008 AT 08:09 A.M.

ORDER NUMBER:11528577

CUSTOMER FILE NUMBER: 6866333

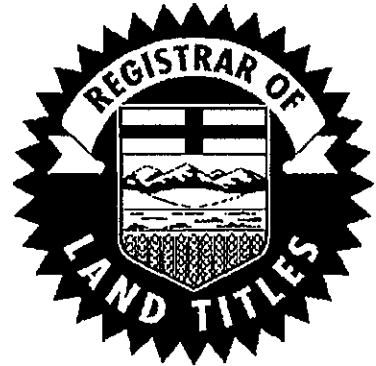

\*END OF CERTIFICATE\*

THIS ELECTRONICALLY TRANSMITTED LAND TITLES PRODUCT IS INTENDED FOR THE  
SOLE USE OF THE ORIGINAL PURCHASER, AND NONE OTHER, SUBJECT TO WHAT IS  
SET OUT IN THE PARAGRAPH BELOW.

THE ABOVE PROVISIONS DO NOT PROHIBIT THE ORIGINAL PURCHASER FROM  
INCLUDING THIS UNMODIFIED PRODUCT IN ANY REPORT, OPINION, APPRAISAL OR  
OTHER ADVICE PREPARED BY THE ORIGINAL PURCHASER AS PART OF THE ORIGINAL  
PURCHASER APPLYING PROFESSIONAL, CONSULTING OR TECHNICAL EXPERTISE FOR  
THE BENEFIT OF CLIENT(S).



HISTORICAL LAND TITLE CERTIFICATE

TITLE CANCELLED ON SEPTEMBER 01, 1998

S  
LINC 0027 602 341 SHORT LEGAL 9824269;4 TITLE NUMBER 982 263 029

LEGAL DESCRIPTION  
PLAN 9824269  
BLOCK 4  
EXCEPTING THEREOUT ALL MINES AND MINERALS  
AREA: 0.59 HECTARES (1.46 ACRES) MORE OR LESS

ESTATE: FEE SIMPLE  
ATS REFERENCE: 5;1;41;1

MUNICIPALITY: LACOMBE COUNTY

REFERENCE NUMBER: 792 125 982

-----  
REGISTERED OWNER(S)  
REGISTRATION DATE(DMY) DOCUMENT TYPE VALUE CONSIDERATION  
-----  
982 263 029 01/09/1998 SUBDIVISION PLAN

OWNERS

SANDY POINT FARMS LTD.  
OF #800, 335-8 AVENUE SW, CALGARY  
ALBERTA

-----  
ENCUMBRANCES, LIENS & INTERESTS  
REGISTRATION  
NUMBER DATE (D/M/Y) PARTICULARS  
-----  
982 263 209 01/09/1998 DESCRIPTIVE PLAN  
AFFECTED LAND: 9824269;4 CANCELLED IN FULL  
TITLE CANCELLED IN FULL  
AFFECTED PLAN: 9824271

( CONTINUED )



TOTAL INSTRUMENTS: 001

THE REGISTRAR OF TITLES CERTIFIES THIS TO BE AN ACCURATE  
REPRODUCTION OF THE CERTIFICATE OF TITLE REPRESENTED  
HEREIN THIS 12 DAY OF JUNE, 2008 AT 08:09 A.M.

ORDER NUMBER: 11528577

CUSTOMER FILE NUMBER: 6866333



\*END OF CERTIFICATE\*

---

THIS ELECTRONICALLY TRANSMITTED LAND TITLES PRODUCT IS INTENDED FOR THE  
SOLE USE OF THE ORIGINAL PURCHASER, AND NONE OTHER, SUBJECT TO WHAT IS  
SET OUT IN THE PARAGRAPH BELOW.

THE ABOVE PROVISIONS DO NOT PROHIBIT THE ORIGINAL PURCHASER FROM  
INCLUDING THIS UNMODIFIED PRODUCT IN ANY REPORT, OPINION, APPRAISAL OR  
OTHER ADVICE PREPARED BY THE ORIGINAL PURCHASER AS PART OF THE ORIGINAL  
PURCHASER APPLYING PROFESSIONAL, CONSULTING OR TECHNICAL EXPERTISE FOR  
THE BENEFIT OF CLIENT(S).



HISTORICAL LAND TITLE CERTIFICATE

TITLE CANCELLED ON SEPTEMBER 01,1998

S

LINC

0012 739 769

0027 602 333

SHORT LEGAL

7921404;1

7921404;3

TITLE NUMBER

982 263 029 +4

LEGAL DESCRIPTION

FIRST

PLAN 7921404

BLOCK ONE (1)

CONTAINING 69.8 HECTARES (172.50 ACRES) MORE OR LESS.

EXCEPTING THEREOUT ALL MINES AND MINERALS

ATS REFERENCE: 5;1;41;12;S

SECOND

PLAN 7921404

BLOCK THREE (3)

CONTAINING 135 HECTARES (333.6 ACRES) MORE OR LESS.

EXCEPTING THEREOUT:

HECTARES (ACRES) MORE OR LESS

A) PLAN 9824269 SUBDIVISION 36.527 90.26

EXCEPTING THEREOUT ALL MINES AND MINERALS

ATS REFERENCE: 5;1;41;1

ESTATE: FEE SIMPLE

MUNICIPALITY: LACOMBE COUNTY

REFERENCE NUMBER: 792 125 982

( CONTINUED )

REGISTRATION	DATE(DMY)	REGISTERED OWNER(S) DOCUMENT TYPE	VALUE	CONSIDERATION
982 263 029	01/09/1998	SUBDIVISION PLAN		

OWNERS

SANDY POINT FARMS LTD.  
OF #800, 335-8 AVENUE SW, CALGARY  
ALBERTA

REGISTRATION NUMBER	DATE (D/M/Y)	ENCUMBRANCES, LIENS & INTERESTS PARTICULARS
982 263 107	01/09/1998	DESCRIPTIVE PLAN AFFECTED LAND: 7921404;3 CANCELLED IN FULL NEW TITLE ISSUED FOR THE REMAINDER AFFECTED PLAN: 9824270

TOTAL INSTRUMENTS: 001

THE REGISTRAR OF TITLES CERTIFIES THIS TO BE AN ACCURATE  
REPRODUCTION OF THE CERTIFICATE OF TITLE REPRESENTED  
HEREIN THIS 12 DAY OF JUNE, 2008 AT 08:09 A.M.

ORDER NUMBER:11528577

CUSTOMER FILE NUMBER: 6866333



\*END OF CERTIFICATE\*

THIS ELECTRONICALLY TRANSMITTED LAND TITLES PRODUCT IS INTENDED FOR THE  
SOLE USE OF THE ORIGINAL PURCHASER, AND NONE OTHER, SUBJECT TO WHAT IS  
SET OUT IN THE PARAGRAPH BELOW.

THE ABOVE PROVISIONS DO NOT PROHIBIT THE ORIGINAL PURCHASER FROM  
INCLUDING THIS UNMODIFIED PRODUCT IN ANY REPORT, OPINION, APPRAISAL OR  
OTHER ADVICE PREPARED BY THE ORIGINAL PURCHASER AS PART OF THE ORIGINAL

( CONTINUED )

PURCHASER APPLYING PROFESSIONAL, CONSULTING OR TECHNICAL EXPERTISE FOR  
THE BENEFIT OF CLIENT(S) .





HISTORICAL LAND TITLE CERTIFICATE

TITLE CANCELLED ON SEPTEMBER 01, 1998

S		
LINC	SHORT LEGAL	TITLE NUMBER
0012 739 769	7921404;1	792 125 982
0012 739 777	7921404;3	

LEGAL DESCRIPTION

FIRST

PLAN 7921404  
BLOCK ONE (1)  
CONTAINING 69.8 HECTARES (172.50 ACRES) MORE OR LESS.  
EXCEPTING THEREOUT ALL MINES AND MINERALS

ATS REFERENCE: 5;1;41;12;S

SECOND

PLAN 7921404  
BLOCK THREE (3)  
CONTAINING 135 HECTARES (333.6 ACRES) MORE OR LESS.  
EXCEPTING THEREOUT ALL MINES AND MINERALS

ATS REFERENCE: 5;1;41;1  
ESTATE: FEE SIMPLE

MUNICIPALITY: LACOMBE COUNTY

REGISTERED OWNER(S)				
REGISTRATION	DATE(DMY)	DOCUMENT TYPE	VALUE	CONSIDERATION
792 125 982	04/06/1979		\$70,086	

OWNERS

SANDY POINT FARMS LTD.  
OF #800, 335-8 AVENUE SW, CALGARY  
ALBERTA

( CONTINUED )

-----  
ENCUMBRANCES, LIENS & INTERESTS

PAGE 2  
# 792 125 982

REGISTRATION NUMBER	DATE (D/M/Y)	PARTICULARS
752 176 698	03/12/1975	RESTRICTIVE COVENANT
982 263 028	01/09/1998	DISCHARGE OF RESTRICTIVE COVENANT 752176698
982 263 029	01/09/1998	SUBDIVISION PLAN 9824269 AFFECTED LAND: 7921404;3 CANCELLED AS TO PART NEW TITLE ISSUED FOR THE REMAINDER

TOTAL INSTRUMENTS: 003

THE REGISTRAR OF TITLES CERTIFIES THIS TO BE AN ACCURATE  
REPRODUCTION OF THE CERTIFICATE OF TITLE REPRESENTED  
HEREIN THIS 12 DAY OF JUNE, 2008 AT 08:09 A.M.

ORDER NUMBER:11528577

CUSTOMER FILE NUMBER: 6866333

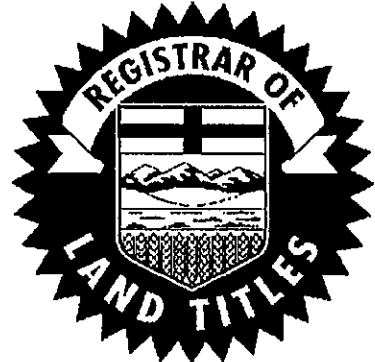

\*END OF CERTIFICATE\*

THIS ELECTRONICALLY TRANSMITTED LAND TITLES PRODUCT IS INTENDED FOR THE  
SOLE USE OF THE ORIGINAL PURCHASER, AND NONE OTHER, SUBJECT TO WHAT IS  
SET OUT IN THE PARAGRAPH BELOW.

THE ABOVE PROVISIONS DO NOT PROHIBIT THE ORIGINAL PURCHASER FROM  
INCLUDING THIS UNMODIFIED PRODUCT IN ANY REPORT, OPINION, APPRAISAL OR  
OTHER ADVICE PREPARED BY THE ORIGINAL PURCHASER AS PART OF THE ORIGINAL  
PURCHASER APPLYING PROFESSIONAL, CONSULTING OR TECHNICAL EXPERTISE FOR  
THE BENEFIT OF CLIENT(S).

# Certificate of Title

Canada

EXTRA REFERENCE:  
752176701



NO.	7	9	2	1	2	5	9	8	2
REF.	7	5	2	1	7	6	7	0	0
VALUES			7	0	0	8	6	2	3

M	RG.	TWP.	SEC.	Q.	PT.
1					

PLAN	BLK.	LOT	PT.
27921404	1		+

## North Alberta Land Registration District

THIS IS TO CERTIFY that SANDY POINT FARMS LTD.  
OF CALGARY IN THE PROVINCE OF ALBERTA

IS now the owner of an estate in fee simple

of and in

PLAN 792 1404

### FIRST:

BLOCK ONE (1)

CONTAINING 69.8 HECTARES (172.50 ACRES) MORE OR LESS.

(S. 1/2 12 - 41 - 1 W. 5TH)

EXCEPTING THEREOUT ALL MINES AND MINERALS.

### SECONDLY:

BLOCK THREE (3)

CONTAINING 135.0 HECTARES (333.6 ACRES) MORE OR LESS.

(PT. 1 - 41 - 1 W. 5TH)

EXCEPTING THEREOUT ALL MINES AND MINERALS.

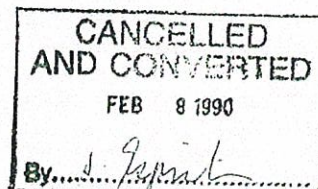

SUBJECT TO THE ENCUMBRANCES, LIENS, ESTATES OR INTERESTS NOTIFIED BY MEMORANDUM OR ENDORSED HEREON, OR WHICH MAY HEREAFTER BE MADE IN THE REGISTER.

IN WITNESS WHEREOF I have hereunto subscribed my name and affixed my official seal

this 4TH day of JUNE, A.D. 1979.

Post Office Address #800, 335 - 8TH AVENUE, S.W.

CALGARY, ALBERTA

SAE

A.G. 699  
Rev. 7/77



*[Signature]*

AD Registrar

North Alberta Land Registration District



## Show Other Abbreviations Here

792 1404 BLK 1 +

**CHARGES, LIEN'S AND INTERESTS.**

ABBREVIATIONS	
E	Easement
C	Caveat
T	Transmission
Tr	Transfer
M	Mortgage
LRW	Utility Right of Way
BL	Builders Lien
TN	Tax Notification
WE	Writ of Execution
C.C.	Covenants and Conditions
ENCUM	Encumbrance

TITLE									
NO.	7	9	2	1	2	5	9	8	2

[illegible]

~~CANCELLED  
AND CONVERTED~~

FEB 8 1990

5

**Appendix 2: Environmental Protection Search**



June 11, 2008

Jeannie Marie Blanchard

Phase 1 Coordinator  
Ecomark Limited  
149<sup>th</sup> Street Business Centre  
Suite 100, 14964 -121A Avenue  
Edmonton, Alberta T5V 1A3

Jeannie Marie,

**RE: Records Search**  
**Your file ADWIL-08105-00-0**

Pursuant to your request dated June 9, 2008 regarding information on Block 8, Plan 982 4271 a review of the land file for the aforementioned property was conducted.

Staff findings indicated that there have been no Bylaw investigations, tickets, or prosecutions of any environmentally related events to date. Further, Lacombe County has no record of any landfills, waste sites, nuisance grounds or environmental incidents on file regarding this property or surrounding sites.

The Assessment Department has confirmed that there is neither any of record reduced property tax assessments nor any applications for reduced property tax due to soil degradation.

The property is designated Agricultural "A" under the County's Land Use Bylaw No. 1056/07 and amendments thereto.

Please do not hesitate to call if you have any questions.

Yours truly,  
LACOMBE COUNTY

  
Amanda-Brea Watson  
Assistant Planner/Development Officer



## **ENVIRONMENTAL LAW CENTRE**

Suite 800, 10025 - 106 Street, Edmonton, AB T5J 1G4

Phone: (780) 424-5099 Fax: (780) 424-5133

Internet: [www.elc.ab.ca](http://www.elc.ab.ca) E-Mail: [elc@elc.ab.ca](mailto:elc@elc.ab.ca)

---

June 13, 2008

Our File: 039288

Ms. Jeannie Marie Blanchard  
Ecomark Ltd.  
149th Street Business Centre  
Suite 100, 14964 - 121 A Avenue  
Edmonton, AB T5V 1A3

Dear Ms. Blanchard:

**RE: Search Requested - Frank Wilson**

In response to your request of June 12, 2008, we have searched the Environmental Enforcement Historical Search Service database for an exact match with respect to the above request, and can advise that as of today's date, there have been NO enforcement actions issued pursuant to the Alberta "Environmental Protection and Enhancement Act" ("EPEA") and its predecessor legislation, the "Hazardous Chemicals Act", "Agricultural Chemicals Act", "Clean Water Act" and "Clean Air Act" to 1971, and/or pursuant to the "Water Act" from 1999 onwards.

This search is limited to the following enforcement actions under EPEA and its predecessor legislation: Tickets, Prosecutions, Administrative Penalties, Warnings, Enforcement Orders, Enforcement Orders Concerning Waste, Environmental Protection Orders, Emergency Environmental Protection Orders, Emission Control Orders, Chemical Control Orders, Water Quality Control Orders and Stop Orders. This search is limited to the following enforcement actions under the Water Act: Prosecutions, Administrative Penalties, Water Management Orders, Warnings and Enforcement Orders. It does not include Clean Up Orders issued under the Litter Act or Environmental Protection Orders respecting unsightly property issued under EPEA; this information may be available from the local municipality.

Enforcement actions are entered in the database following: (1) the decision date, for prosecutions; (2) the date an administrative penalty was paid or due (30 days after issuance), whichever is sooner; and (3) the date the document was issued for all other enforcement actions.

These search results are based on information provided by Alberta Environment ("AENV"). AENV advises that they try to provide the best information possible. However, AENV advises that it cannot guarantee that the information provided is complete or accurate and that any person relying on these search results does so at their own risk. More information may be gained by referring to original enforcement documents.

Copies of orders are available from the Environmental Law Centre. Any other enforcement information may be available directly from Alberta Environment.

Yours sincerely,



Cindy Dewing  
Enforcement Search Service  
Encl.

## **ENVIRONMENTAL LAW CENTRE**

Suite 800, 10025 - 106 Street, Edmonton, AB T5J 1G4

Phone: (780) 424-5099 Fax: (780) 424-5133

Internet: [www.elc.ab.ca](http://www.elc.ab.ca) E-Mail: [elc@elc.ab.ca](mailto:elc@elc.ab.ca)

---

June 13, 2008

Our File: 039289

Ms. Jeannie Marie Blanchard  
Ecomark Ltd.  
149th Street Business Centre  
Suite 100, 14964 - 121 A Avenue  
Edmonton, AB T5V 1A3

Dear Ms. Blanchard:

**RE: Search Requested - Sandy Point Farms Ltd.**

In response to your request of June 12, 2008, we have searched the Environmental Enforcement Historical Search Service database for an exact match with respect to the above request, and can advise that as of today's date, there have been NO enforcement actions issued pursuant to the Alberta "Environmental Protection and Enhancement Act" ("EPEA") and its predecessor legislation, the "Hazardous Chemicals Act", "Agricultural Chemicals Act", "Clean Water Act" and "Clean Air Act" to 1971, and/or pursuant to the "Water Act" from 1999 onwards.

This search is limited to the following enforcement actions under EPEA and its predecessor legislation: Tickets, Prosecutions, Administrative Penalties, Warnings, Enforcement Orders, Enforcement Orders Concerning Waste, Environmental Protection Orders, Emergency Environmental Protection Orders, Emission Control Orders, Chemical Control Orders, Water Quality Control Orders and Stop Orders. This search is limited to the following enforcement actions under the Water Act: Prosecutions, Administrative Penalties, Water Management Orders, Warnings and Enforcement Orders. It does not include Clean Up Orders issued under the Litter Act or Environmental Protection Orders respecting unsightly property issued under EPEA; this information may be available from the local municipality.

Enforcement actions are entered in the database following: (1) the decision date, for prosecutions; (2) the date an administrative penalty was paid or due (30 days after issuance), whichever is sooner; and (3) the date the document was issued for all other enforcement actions.

These search results are based on information provided by Alberta Environment ("AENV"). AENV advises that they try to provide the best information possible. However, AENV advises that it cannot guarantee that the information provided is complete or accurate and that any person relying on these search results does so at their own risk. More information may be gained by referring to original enforcement documents.

Copies of orders are available from the Environmental Law Centre. Any other enforcement information may be available directly from Alberta Environment.

Yours sincerely,



Cindy Dewing  
Enforcement Search Service  
Encl.

## **ENVIRONMENTAL LAW CENTRE**

Suite 800, 10025 - 106 Street, Edmonton, AB T5J 1G4

Phone: (780) 424-5099 Fax: (780) 424-5133

E-Mail: [elc@elc.ab.ca](mailto:elc@elc.ab.ca) Home Page: <http://www.elc.ab.ca>

---

June 19, 2008

Our File: 019514

Ms. Jeannie Marie Blanchard  
Ecomark Ltd.  
149th Street Business Centre  
Suite 100, 14964 - 121 A Avenue  
Edmonton, AB T5V 1A3

Dear Ms. Blanchard:

**RE: Search Requested - S[E]-12-41-1-W5M**

In response to your request of June 18, 2008, we have searched the Wellsite Reclamation Historical Search Service database for the following quarter section of land:

**W5-01-041-12 SE1/4**

and can advise that as of today's date, there have been NO Reclamation Certificates (applied for, issued or cancelled), Reclamation Orders and Conservation and Reclamation Notices issued pursuant to the "Alberta Environmental Protection and Enhancement Act" and its predecessor legislation, the "Land Surface Conservation and Reclamation Act" and the "Surface Reclamation Act" since 1963.

Information offered by the Wellsite Reclamation Historical Search Service is limited to wellsites, oil production sites, pipelines, compressor sites and some sand and gravel operations on Alberta private land, Special Areas Board land constituted under the "Special Areas Act" and Metis Settlements established under the "Metis Settlements Act". Not included are coal or oil sands mines or exploration sites.

These search results are based on information provided by Alberta Environment ("AENV"). AENV advises that they try to provide the best information possible. However, AENV advises that it cannot guarantee that the information provided is complete or accurate and that any person relying on these search results does so at their own risk.

Information about Environmental Protection Orders, Emergency Environment Protection Orders and Enforcement Orders issued under the "Alberta Environmental Protection and Enhancement Act" can be obtained by searching the Environmental Enforcement Historical Search Service database through the Environmental Law Centre.

Yours sincerely,

  
Cathy Halonen  
Wellsite Reclamation Search Service Coordinator  
/id  
Encl.



## **ENVIRONMENTAL LAW CENTRE**

Suite 800, 10025 - 106 Street, Edmonton, AB T5J 1G4

Phone: (780) 424-5099 Fax: (780) 424-5133

E-Mail: [elc@elc.ab.ca](mailto:elc@elc.ab.ca) Home Page: <http://www.elc.ab.ca>

---

June 19, 2008

Our File: 019515

Ms. Jeannie Marie Blanchard  
Ecomark Ltd.  
149th Street Business Centre  
Suite 100, 14964 - 121 A Avenue  
Edmonton, AB T5V 1A3

Dear Ms. Blanchard:

**RE: Search Requested - S[W]-12-41-1-W5M**

In response to your request of June 18, 2008, we have searched the Wellsite Reclamation Historical Search Service database for the following quarter section of land:

**W5-01-041-12 SW1/4**

and can advise that as of today's date, there have been NO Reclamation Certificates (applied for, issued or cancelled), Reclamation Orders and Conservation and Reclamation Notices issued pursuant to the "Alberta Environmental Protection and Enhancement Act" and its predecessor legislation, the "Land Surface Conservation and Reclamation Act" and the "Surface Reclamation Act" since 1963.

Information offered by the Wellsite Reclamation Historical Search Service is limited to wellsites, oil production sites, pipelines, compressor sites and some sand and gravel operations on Alberta private land, Special Areas Board land constituted under the "Special Areas Act" and Metis Settlements established under the "Metis Settlements Act". Not included are coal or oil sands mines or exploration sites.

These search results are based on information provided by Alberta Environment ("AENV"). AENV advises that they try to provide the best information possible. However, AENV advises that it cannot guarantee that the information provided is complete or accurate and that any person relying on these search results does so at their own risk.

Information about Environmental Protection Orders, Emergency Environment Protection Orders and Enforcement Orders issued under the "Alberta Environmental Protection and Enhancement Act" can be obtained by searching the Environmental Enforcement Historical Search Service database through the Environmental Law Centre.

Yours sincerely,



Cathy Halonen  
Wellsite Reclamation Search Service Coordinator  
/id  
Encl.

## Appendix 3: Petroleum Tank Management Association

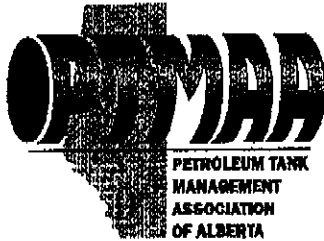

Petroleum Tank Management  
Association of Alberta

Suite 980, 10303 Jasper Avenue  
Edmonton, Alberta T5J 3N6  
PH: (780)425-8265 or 1-866-222-8265  
FAX: (780)425-4722

June 18, 2008

Jeannie Blanchard  
Ecomark Limited  
14964 121 A Avenue Suite 100  
Edmonton, AB  
T5V 1A3

Dear Jeannie Blanchard:

As per your request, the PTMAA has checked the registration of active tank sites and inventory of abandoned tank sites and there are no records for the property with the legal land description:

Plan 9824271, Block 8, Lacombe  
S1/2 12-41-1-W5

Please note that both databases are not complete. The main limitation of these databases is that they only include information reported through registration or a survey of abandoned sites completed in 1992 and should not be considered as a comprehensive inventory of all past or present storage tank sites. The PTMAA **cannot** guarantee that tanks do not or have not existed at this location. Information in the databases is based on information supplied by the owner and the PTMAA cannot guarantee its accuracy. Information on storage tanks or on past or present contaminant investigations may be filed with the local Fire Department or Alberta Environment.

Yours truly,

A handwritten signature in black ink, appearing to read 'Connie Jacobsen', is positioned above the printed name.

Connie Jacobsen  
PTMAA

# TELUS Geomatics - Alberta Map

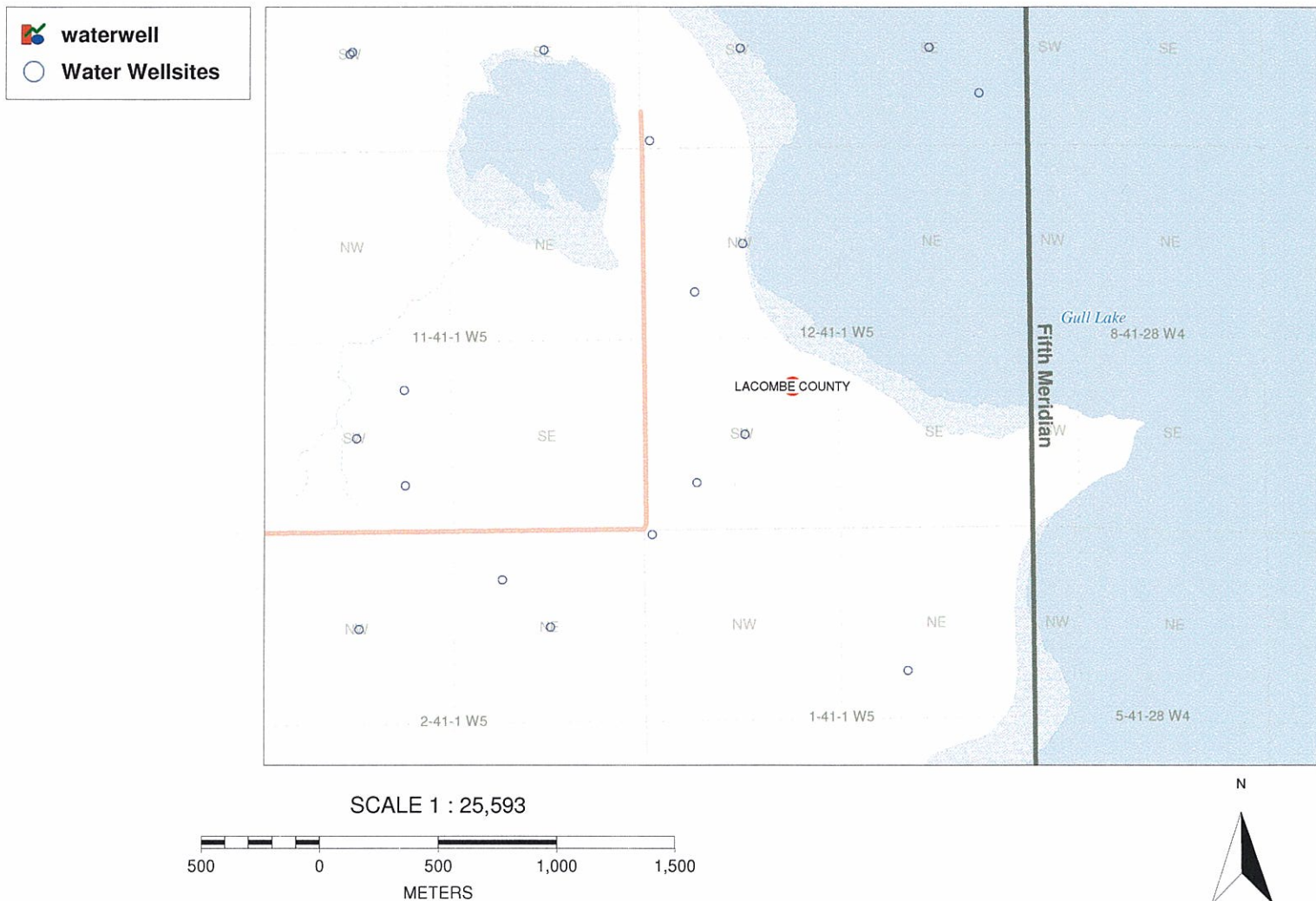





# Water Well Drilling Report

The data contained in this report is supplied by the Driller. The province disclaims responsibility for its accuracy.

Well I.D.: 0497115  
 Map Verified: Not Verified  
 Date Report: 2000/11/24  
 Received:  
 Measurements: Metric

## 1. Contractor & Well Owner Information

Company Name: TALL PINE DRILLING LTD.  
 Mailing Address: BOX 700  
 Well Owner's Name: FOUNDERS ENERGY LTD  
 P.O. Box Number:  
 City: Province: Country:  
 Drilling Company Approval No.: 119166  
 City or Town: BENTLEY AB CA  
 Well Location Identifier:  
 Mailing Address: 2800 300 5 AVE SW, CALGARY  
 Postal Code: T2P 3C4  
 Province: Country:

## 2. Well Location

1/4 or Sec Twp Rge West of  
 LSD 06 12 041 01 5 M  
 Location in Quarter  
 0 M from Boundary  
 0 M from Boundary  
 Lot Block Plan  
 Well Elev: M How Obtain: Not Obtain

## 3. Drilling Information

Type of Work: New Well-Abandoned  
 Reclaimed Well  
 Date Reclaimed: 2000/09/04  
 Method of Drilling: Rotary  
 Flowing Well: No  
 Gas Present: No  
 Materials Used: Cement  
 Rate: Liters  
 Oil Present: No  
 Proposed well use: Industrial  
 Anticipated Water Requirements/day: 4546 Liters

## 6. Well Yield

Test Date (yyyy/mm/dd): 2000/08/22  
 Start Time: 9:00 AM  
 Test Method: Air  
 Non pumping static level: 12.8 M  
 Rate of water removal: 250.03 Liters/Min  
 Depth of pump intake: 42.67 M  
 Water level at end of pumping: M  
 Distance from top of CM casing to ground level:  
 Depth To water level (meters)  
 Elapsed Time  
 Drawdown Minutes:Sec Recovery  
 1:00 24.99  
 2:00 23.47  
 3:00 21.03  
 4:00 18.29  
 5:00 16.76  
 6:00 15.54  
 7:00 14.63  
 8:00 14.02  
 9:00 13.41  
 10:00 12.8  
 16:00 12.8  
 Total Drawdown: 0 M  
 If water removal was less than 2 hr duration, reason why:

## 4. Formation Log

Depth from ground level (meters)  
 Lithology Description  
 12.19 Clay  
 21.34 Gray Shale  
 27.43 Green Shale  
 36.58 Gray Shale  
 48.77 Gray Sandstone

## 5. Well Completion

Date Started (yyyy/mm/dd): 2000/08/22  
 Date Completed (yyyy/mm/dd): 2000/08/22  
 Well Depth: 48.77 M  
 Casing Type: Steel  
 Size OD: 13.97 CM  
 Wall Thickness: 0.1 CM  
 Borehole Diameter: 0 CM  
 Liner Type: Steel  
 Size OD: 11.43 CM  
 Wall Thickness: 0.6 CM  
 Bottom at: 6.1 M  
 Top: 0.91 M Bottom: 48.77 M  
 Perforations from: 36.58 M to: 48.77 M  
 Perforations Size: 1.43 CM x 15.24 CM  
 from: 0 M to: 0 M 0 CM x 0 CM  
 from: 0 M to: 0 M 0 CM x 0 CM  
 Perforated by: Machine  
 Seal: Driven  
 from: 0 M to: 6.1 M  
 Seal:  
 from: 0 M to: 0 M  
 Seal:  
 from: 0 M to: 0 M  
 Screen Type: Screen ID: 0 CM  
 from: 0 M to: 0 M Slot Size: 0 CM  
 Screen Type: Screen ID: 0 CM  
 from: 0 M to: 0 M Slot Size: 0 CM  
 Screen Installation Method:  
 Fittings  
 Top: Bottom:  
 Pack:  
 Grain Size: Amount:  
 Geophysical Log Taken:  
 Retained on Files:  
 Additional Test and/or Pump Data  
 Chemistries taken By Driller: No  
 Held: 0 Documents Held: 1  
 Pitless Adapter Type:  
 Drop Pipe Type:  
 Length: M Diameter: CM  
 Comments:  
 DRILLER REPORTS DISTANCE FROM TOP OF CASING TO GROUND LEVEL: 3'. CASING PULLED.

## 7. Contractor Certification

Driller's Name: UNKNOWN DRILLER  
 Certification No.: 33716A  
 This well was constructed in accordance with the Water

Well regulation of the Alberta Environmental Protection  
& Enhancement Act. All information in this report is true.  
Signature Yr Mo Day

**Report 1 Pump Test 1**



# Water Well Drilling Report

The data contained in this report is supplied by the Driller. The province disclaims responsibility for its accuracy.

Well I.D.: 0435955  
 Map Verified: Map  
 Date Report: 1983/05/30  
 Received:  
 Measurements: Metric

## 1. Contractor & Well Owner Information

Company Name: FLINN DRILLING LTD.  
 Mailing Address: GENERAL DELIVERY  
 Well Owner's Name: SANDY POINT FARMS  
 P.O. Box Number:  
 City:  
 Province:  
 Country:  
 Drilling Company Approval No.: ZZZZZZ  
 City or Town: LACOMBE AB CA  
 Well Location Identifier:  
 Mailing Address: ST ALBERT  
 Postal Code:  
 Rate: Liters  
 Oil Present: No

## 2. Well Location

1/4 or Sec Twp Rge West of  
 LSD 04 12 041 01 M 5  
 Location in Quarter  
 0 M from Boundary  
 0 M from Boundary  
 Lot Block Plan  
 Well Elev: M  
 How Obtain: Not Obtain

## 3. Drilling Information

Type of Work: Test Hole  
 Reclaimed Well  
 Date Reclaimed:  
 Method of Drilling: Cable Tool  
 Flowing Well: No  
 Gas Present: No  
 Proposed well use: Stock  
 Anticipated Water Requirements/day  
 0 Liters

## 6. Well Yield

Test Date: 1983/05/05  
 Start Time: 11:00 AM  
 Test Method: Bailer  
 Non pumping static level: 0 M

## 4. Formation Log

Depth from ground level (meters)  
**Lithology Description**  
 1.52 Sand & Till  
 4.57 Yellow Clay & Shale  
 7.62 Greenish Yellow Shale  
 8.53 Sand & Till  
 12.19 Gray Shale  
 14.02 Gray Shale & Rocks  
 17.68 Gray Sand  
 27.13 Gray Shale  
 28.96 Gray Sand  
 34.44 Blue Gray Shale  
 43.89 Light Gray Sand  
 46.63 Brownish Gray Shale  
 48.77 Gray Sand

## 5. Well Completion

Date Started (yyyy/mm/dd): 1983/05/03  
 Date Completed (yyyy/mm/dd): 1983/05/05  
 Well Depth: 48.77 M  
 Borehole Diameter: 0 CM  
 Casing Type: Steel  
 Liner Type: Steel  
 Size OD: 14.12 CM  
 Size OD: 11.43 CM  
 Wall Thickness: 0.48 CM  
 Wall Thickness: 0 CM  
 Bottom at: 12.19 M  
 Top: 0 M Bottom: 48.77 M  
 Perforations from: 12.19 M to: 48.77 M  
 Perforations Size: 0.32 CM x 45.72 CM  
 from: 0 M to: 0 M  
 0 CM x 0 CM  
 from: 0 M to: 0 M  
 0 CM x 0 CM  
 Perforated by: Torch  
 Seal: Driven  
 from: 0 M to: 12.19 M  
 Seal:  
 from: 0 M to: 0 M  
 Seal:  
 from: 0 M to: 0 M  
 Screen Type:  
 from: 0 M to: 0 M  
 Screen ID: 0 CM  
 Slot Size: 0 CM  
 Screen Type:  
 from: 0 M to: 0 M  
 Screen ID: 0 CM  
 Slot Size: 0 CM  
 Screen Installation Method:  
 Fittings  
 Top: Bottom:  
 Pack:  
 Grain Size: Amount:  
 Geophysical Log Taken:  
 Retained on Files:  
 Additional Test and/or Pump Data  
 Chemistries taken By Driller: No  
 Held: 0 Documents Held: 1  
 Pitless Adapter Type:  
 Drop Pipe Type:  
 Length: M Diameter: CM  
 Comments:

Rate of water removal: 181.84 Liters/Min  
 Depth of pump intake: 3.66 M  
 Water level at end of pumping: M  
 Distance from top of CM casing to ground level:  
 Depth To water level (meters)  
 Elapsed Time  
 Drawdown Minutes: Sec Recovery  
 Total Drawdown: 8.53 M  
 If water removal was less than 2 hr duration, reason why:

Recommended pumping rate: 0 Liters/Min  
 Recommended pump intake: 0 M

Type Pump Installed  
 Pump Type:  
 Pump Model:  
 H.P.:  
 Any further pumptest information?

## 7. Contractor Certification

Driller's Name: UNKNOWN DRILLER  
 Certification No.:  
 This well was constructed in accordance with the Water

Well regulation of the Alberta Environmental Protection & Enhancement Act. All information in this report is true.	
Signature	Yr Mo Day

Report 1 Pump Test 1 page1





## Water Well Drilling Report

The data contained in this report is supplied by the Driller. The province disclaims responsibility for its accuracy.

Well I.D.: 0478956  
 Map Verified: Field  
 Date Report: 1950/08/17  
 Received:  
 Measurements: Metric

### 1. Contractor & Well Owner Information

Company Name: ERICKSON DRILLING  
 Mailing Address: City or Town: Postal Code:  
 Well Owner's Name: NORVILLA, C.  
 P.O. Box Number: Mailing Address: BENTLEY Postal Code:  
 City: Province: Country:

Drilling Company Approval No.:

### 2. Well Location

1/4 or Sec Twp Rge West of  
 LSD M  
 NW 12 041 01 5  
 Location in Quarter  
 0 M from Boundary  
 0 M from Boundary  
 Lot Block Plan  
 Well Elev: 905.56 M How Obtain: Survey-Air

### 3. Drilling Information

Type of Work: Federal Well Survey  
 Reclaimed Well  
 Date Reclaimed: Materials Used:  
 Method of Drilling: Drilled  
 Flowing Well: Rate: Liters  
 Gas Present: No Oil Present: No  
 Proposed well use:  
 Domestic & Stock  
 Anticipated Water  
 Requirements/day  
 0 Liters

### 6. Well Yield

Test Date: 1950/08/17 Start Time: 11:00 AM  
 Test Method:  
 Non pumping static level: 4.57 M  
 Rate of water removal: Liters/Min  
 Depth of pump intake: 0 M  
 Water level at end of pumping: M  
 Distance from top of CM casing to ground level:  
 Depth To water level (meters)  
 Elapsed Time  
 Drawdown Minutes: Sec Recovery  
 Total Drawdown: 0 M  
 If water removal was less than 2 hr duration, reason why:  
 Recommended pumping rate: 0 Liters/Min  
 Recommended pump intake: 0 M  
 Type Pump Installed  
 Pump Type:  
 Pump Model:  
 H.P.:  
 Any further pumptest information?

### 4. Formation Log

Depth from ground level (meters)  
 Lithology Description

### 5. Well Completion

Date Started (yyyy/mm/dd): Date Completed (yyyy/mm/dd):  
 1946/01/01  
 Well Depth: 36.58 M Borehole Diameter: 0 CM  
 Casing Type: Galvanized Steel Liner Type:  
 Size OD: 5.08 CM Size OD: 0 CM  
 Wall Thickness: 0 CM Wall Thickness: 0 CM  
 Bottom at: 0 M Top: 0 M Bottom: 0 M  
 Perforations from: 0 M to: 0 M Perforations Size: 0 CM x 0 CM  
 from: 0 M to: 0 M 0 CM x 0 CM  
 from: 0 M to: 0 M 0 CM x 0 CM  
 Perforated by:  
 Seal: from: 0 M to: 0 M  
 Seal: from: 0 M to: 0 M  
 Seal: from: 0 M to: 0 M  
 Screen Type: Screen ID: 0 CM  
 from: 0 M to: 0 M Slot Size: 0 CM  
 Screen Type: Screen ID: 0 CM  
 from: 0 M to: 0 M Slot Size: 0 CM  
 Screen Installation Method:  
 Fittings  
 Top: Bottom:  
 Pack:  
 Grain Size: Amount:  
 Geophysical Log Taken:  
 Retained on Files:  
 Additional Test and/or Pump Data  
 Chemistries taken By Driller: No  
 Held: 0 Documents Held: 1  
 Pitless Adapter Type:  
 Drop Pipe Type:  
 Length: M Diameter: CM  
 Comments:  
 SURVEY REPORTS WATER IS CLEAR AND SOFT

### 7. Contractor Certification

Driller's Name: UNKNOWN DRILLER  
 Certification No.:  
 This well was constructed in accordance with the Water

Well regulation of the Alberta Environmental Protection  
& Enhancement Act. All information in this report is true.  
Signature Yr Mo Day

Report 1 Pump Test 1



## Water Well Drilling Report

The data contained in this report is supplied by the Driller. The province disclaims responsibility for its accuracy.

Well I.D.: 0435957  
 Map Verified: Map  
 Date Report  
 Received:  
 Measurements: Metric

### 1. Contractor & Well Owner Information

Company Name: GERMAN R E Drilling Company Approval No.:  
 Mailing Address: City or Town: Postal Code:  
 Well Owner's Name: NORRILA, PAUL Well Location Identifier:  
 P.O. Box Number: 131 Mailing Address: BENTLEY Postal Code:  
 City: Province: Country:

### 2. Well Location

1/4 or Sec Twp Rge West of  
 LSD M  
 12 12 041 01 5  
 Location in Quarter  
 0 M from Boundary  
 0 M from Boundary  
 Lot Block Plan  
 Well Elev: 911.35 M How Obtain: Estimated

### 3. Drilling Information

Type of Work: Well Inventory Proposed well use:  
 Reclaimed Well Stock  
 Date Reclaimed: Materials Used: Anticipated Water  
 Method of Drilling: Drilled Requirements/day  
 Flowing Well: No Rate: Liters 0 Liters  
 Gas Present: No Oil Present: No

### 6. Well Yield

Test Date Start Time:  
 (yyyy/mm/dd):  
 Test Method:  
 Non pumping M  
 static level:  
 Rate of water Liters/Min  
 removal:  
 Depth of M  
 pump intake:  
 Water level at M  
 end of  
 pumping:  
 Distance from CM  
 top of casing  
 to ground  
 level:  
 Depth To water level (meters)  
 Elapsed Time  
 Drawdown Minutes: Sec Recovery

### 4. Formation Log

Depth from ground level (meters)  
 Lithology Description

### 5. Well Completion

Date Started(yyyy/mm/dd): Date Completed (yyyy/mm/dd):  
 1963/01/01  
 Well Depth: 15.24 M Borehole Diameter: 0 CM  
 Casing Type: Liner Type:  
 Size OD: 0 CM Size OD: 0 CM  
 Wall Thickness: 0 CM Wall Thickness: 0 CM  
 Bottom at: 0 M Top: 0 M Bottom: 0 M  
 Perforations Perforations Size:  
 from: 0 M to: 0 M 0 CM x 0 CM  
 from: 0 M to: 0 M 0 CM x 0 CM  
 from: 0 M to: 0 M 0 CM x 0 CM  
 Perforated by:  
 Seal:  
 from: 0 M to: 0 M  
 Seal:  
 from: 0 M to: 0 M  
 Seal:  
 from: 0 M to: 0 M  
 Screen Type: Screen ID: 0 CM  
 from: 0 M to: 0 M Slot Size: 0 CM  
 Screen Type: Screen ID: 0 CM  
 from: 0 M to: 0 M Slot Size: 0 CM  
 Screen Installation Method:  
 Fittings Bottom:  
 Pack:  
 Grain Size: Amount:  
 Geophysical Log Taken:  
 Retained on Files:  
 Additional Test and/or Pump Data  
 Chemistries taken By Driller: Yes  
 Held: 0 Documents Held: 1  
 Pitless Adapter Type:  
 Drop Pipe Type:  
 Length: Diameter:  
 Comments:  
 OWNER REPORTS MED HARD WATER.

Total Drawdown: M  
 If water removal was less than 2 hr  
 duration, reason why:  
 Recommended pumping rate:  
 Liters/Min  
 Recommended pump intake: M  
 Type pump installed  
 Pump type:  
 Pump model:  
 H.P.:  
 Any further pump test information?

### 7. Contractor Certification

Driller's Name: UNKNOWN DRILLER  
 Certification No.:  
 This well was constructed in accordance with the Water

Well regulation of the Alberta Environmental Protection & Enhancement Act. All information in this report is true.	
Signature	Yr Mo Day

Report 1





# Water Well Drilling Report

The data contained in this report is supplied by the Driller. The province disclaims responsibility for its accuracy.

Well I.D.: 0341923  
 Map Verified: Map  
 Date Report: 2002/12/11  
 Received:  
 Measurements: Metric

## 1. Contractor & Well Owner Information

Company Name: ALKEN BASIN DRILLING LTD.  
 Drilling Company Approval No.: 38394  
 Mailing Address: BOX 47  
 City or Town: BENTLEY AB CANADA  
 Postal Code: T0C 0J0  
 Well Owner's Name: SANDY POINT FARMS  
 Well Location Identifier:  
 P.O. Box Number: 119  
 Mailing Address: BENTLEY  
 Postal Code: T0C 0J0  
 City: Province: Country:

## 2. Well Location

1/4 or Sec Twp Rge West of  
 LSD M  
 10 01 041 01 5  
 Location in Quarter  
 0 M from Boundary  
 0 M from Boundary  
 Lot Block Plan  
 Well Elev: M  
 How Obtain: Not Obtain

## 3. Drilling Information

Type of Work: New Well  
 Reclaimed Well  
 Date Reclaimed:  
 Method of Drilling: Rotary  
 Flowing Well: No  
 Gas Present: No  
 Proposed well use:  
 Stock  
 Anticipated Water  
 Requirements/day  
 0 Liters  
 Materials Used:  
 Rate: Liters  
 Oil Present: No

## 6. Well Yield

Test Date (yyyy/mm/dd): 2002/11/13  
 Start Time: 11:00 AM  
 Test Method: Air  
 Non pumping static level: 7.01 M  
 Rate of water removal: 90.92 Liters/Min  
 Depth of pump intake: 27.43 M  
 Water level at end of pumping: 12.19 M  
 Distance from top of CM casing to ground level:  
 Depth To water level (meters)  
 Elapsed Time  
 Drawdown Minutes: Sec Recovery  
 9.65 1:00 8.25  
 10.7 2:00 7.98  
 11.12 3:00 7.86  
 11.35 4:00 7.76  
 11.45 5:00 7.75  
 11.52 6:00 7.73  
 11.58 7:00 7.69  
 11.62 8:00 7.67  
 11.64 9:00 7.64  
 11.66 10:00 7.63  
 11.76 14:00 7.58  
 11.78 20:00 7.54  
 11.85 25:00 7.53  
 11.92 30:00 7.5  
 12.17 40:00 7.47  
 12.25 50:00 7.44  
 12.4 60:00 7.43  
 12.25 75:00 7.41  
 12.15 90:00 7.38  
 12.31 120:00 7.33

## 4. Formation Log

Depth from ground level (meters)  
 Lithology Description  
 5.18 Brown Clay  
 7.32 Brown Sandstone  
 9.14 Brown Shale  
 10.36 Brownish Green Sandstone  
 11.28 Brownish Green Fractured Shale  
 12.19 Gray Shale  
 13.41 Gray Hard Sandstone  
 17.07 Gray Shale  
 17.98 Gray Sandstone  
 21.34 Gray Shale  
 22.25 Green Shale  
 24.69 Gray Sandstone  
 27.43 Gray Shale

## 5. Well Completion

Date Started (yyyy/mm/dd): 2002/11/13  
 Date Completed (yyyy/mm/dd): 2002/11/13  
 Well Depth: 27.43 M  
 Borehole Diameter: 0 CM  
 Casing Type: Steel  
 Liner Type: Plastic  
 Size OD: 14.12 CM  
 Size OD: 11.43 CM  
 Wall Thickness: 0.66 CM  
 Wall Thickness: 0.54 CM  
 Bottom at: 11.28 M  
 Top: 9.14 M  
 Bottom: 27.43 M  
 Perforations from: 21.34 M to: 24.38 M  
 Perforations Size: 1.27 CM x 1.27 CM  
 from: 0 M to: 0 M  
 0 CM x 0 CM  
 from: 0 M to: 0 M  
 0 CM x 0 CM  
 Perforated by: Hand Drill  
 Seal: Driven & Bentonite  
 from: 0 M to: 11.28 M  
 Seal:  
 from: 0 M to: 0 M  
 Seal:  
 from: 0 M to: 0 M  
 Screen Type: Screen ID: 0 CM  
 from: 0 M to: 0 M  
 Slot Size: 0 CM  
 Screen Type: Screen ID: 0 CM  
 from: 0 M to: 0 M  
 Slot Size: 0 CM  
 Screen Installation Method:  
 Fittings  
 Top: Bottom:  
 Pack:  
 Grain Size: Amount:  
 Geophysical Log Taken:  
 Retained on Files:  
 Additional Test and/or Pump Data  
 Chemistries taken By Driller: No  
 Held: 0 Documents Held: 1  
 Pitless Adapter Type:  
 Drop Pipe Type:  
 Length: M Diameter: CM  
 Comments:

Total Drawdown: 5.18 M  
 If water removal was less than 2 hr duration, reason why:

Recommended pumping rate: 90.92 Liters/Min  
 Recommended pump intake: 21.34 M  
 Type Pump Installed  
 Pump Type:  
 Pump Model:  
 H.P.:  
 Any further pump test information?

## 7. Contractor Certification

Driller's Name: UNKNOWN DRILLER  
 Certification No.: VA3129  
 This well was constructed in accordance with the Water

Well regulation of the Alberta Environmental Protection  
& Enhancement Act. All information in this report is true.  
Signature Yr Mo Day

Report 1 Pump Test 1 page1



## Water Well Drilling Report

The data contained in this report is supplied by the Driller. The province disclaims responsibility for its accuracy.

Well I.D.: 0435633  
 Map Verified: Not Verified  
 Date Report Received:  
 Measurements: **Metric**

### 1. Contractor & Well Owner Information

Company Name: UNKNOWN DRILLER Drilling Company Approval No.: 99999  
 Mailing Address: UNKNOWN City or Town: UNKNOWN AB CA Postal Code:  
 Well Owner's Name: CALIFORNIA STANDARD CO#THE-500 Well Location Identifier:  
 P.O. Box Number: Mailing Address: Postal Code:  
 City: Province: Country:

### 2. Well Location

1/4 or Sec Twp Rge West of  
 LSD 13 01 041 01 M 5  
 Location in Quarter  
 15.54 M from N Boundary  
 10.97 M from W Boundary  
 Lot Block Plan  
 Well Elev: 932.63 M How Obtain: Survey-Tra

### 3. Drilling Information

Type of Work: Structure Test Hole Reclaimed Well Proposed well use: Unknown  
 Date Reclaimed: Materials Used: Anticipated Water Requirements/day 0 Liters  
 Method of Drilling: Unknown  
 Flowing Well: No Rate: Liters  
 Gas Present: No Oil Present: No

### 6. Well Yield

Test Date Start Time:  
 (yyyy/mm/dd):  
 Test Method:  
 Non pumping M  
 static level:  
 Rate of water Liters/Min  
 removal:  
 Depth of M  
 pump intake:  
 Water level at M  
 end of  
 pumping:  
 Distance from CM  
 top of casing  
 to ground  
 level:  
 Depth To water level (meters)  
 Elapsed Time  
 Drawdown Minutes: Sec Recovery  
 Total Drawdown: M  
 If water removal was less than 2 hr  
 duration, reason why:

### 4. Formation Log

Depth from ground level (meters)  
**Lithology Description**

### 5. Well Completion

Date Started(yyyy/mm/dd): Date Completed (yyyy/mm/dd): 1953/06/29  
 Well Depth: 329.18 M Borehole Diameter: 0 CM  
 Casing Type: Liner Type:  
 Size OD: 0 CM Size OD: 0 CM  
 Wall Thickness: 0 CM Wall Thickness: 0 CM  
 Bottom at: 0 M Top: 0 M Bottom: 0 M  
 Perforations Perforations Size:  
 from: 0 M to: 0 M 0 CM x 0 CM  
 from: 0 M to: 0 M 0 CM x 0 CM  
 from: 0 M to: 0 M 0 CM x 0 CM  
 Perforated by:  
 Seal:  
 from: 0 M to: 0 M  
 Seal:  
 from: 0 M to: 0 M  
 Seal:  
 from: 0 M to: 0 M  
 Screen Type: Screen ID: 0 CM  
 from: 0 M to: 0 M Slot Size: 0 CM  
 Screen Type: Screen ID: 0 CM  
 from: 0 M to: 0 M Slot Size: 0 CM  
 Screen Installation Method:  
 Fittings  
 Top: Bottom:  
 Pack:  
 Grain Size: Amount:  
 Geophysical Log Taken: ELECTRIC  
 Retained on Files: ELECTRIC yes  
 Additional Test and/or Pump Data  
 Chemistries taken By Driller: No  
 Held: 0 Documents Held: 1  
 Pitless Adapter Type:  
 Drop Pipe Type:  
 Length: Diameter:  
 Comments:

### 7. Contractor Certification

Driller's Name: UNKNOWN DRILLER  
 Certification No.:

This well was constructed in accordance with the Water  
Well regulation of the Alberta Environmental Protection  
& Enhancement Act. All information in this report is true.  
Signature Yr Mo Day

Report 1





# Water Well Drilling Report

The data contained in this report is supplied by the Driller. The province disclaims responsibility for its accuracy.

Well I.D.: 0435956  
 Map Verified: Map  
 Date Report Received:  
 Measurements: Metric

## 1. Contractor & Well Owner Information

Company Name: ERICKSON DRILLING Drilling Company Approval No.:  
 Mailing Address: City or Town: Postal Code:  
 Well Owner's Name: NORRILA, P. Well Location Identifier:  
 P.O. Box Number: 131 Mailing Address: BENTLEY Postal Code:  
 City: Province: Country:

## 2. Well Location

1/4 or Sec Twp Rge West of  
 LSD M  
 12 12 041 01 5  
 Location in Quarter  
 0 M from Boundary  
 0 M from Boundary  
 Lot Block Plan  
 Well Elev: 911.35 M How Obtain: Estimated

## 3. Drilling Information

Type of Work: Well Inventory Proposed well use:  
 Reclaimed Well Domestic  
 Date Reclaimed: Materials Used: Anticipated Water  
 Method of Drilling: Drilled Requirements/day  
 Flowing Well: No Rate: Liters 0 Liters  
 Gas Present: No Oil Present: No

## 6. Well Yield

Test Date Start Time:  
 (yyyy/mm/dd):  
 Test Method:  
 Non pumping M  
 static level:  
 Rate of water Liters/Min  
 removal:  
 Depth of M  
 pump intake:  
 Water level at M  
 end of  
 pumping:  
 Distance from CM  
 top of casing  
 to ground  
 level:  
 Depth To water level (meters)  
 Elapsed Time  
 Drawdown Minutes:Sec Recovery  
 Total Drawdown: M  
 If water removal was less than 2 hr  
 duration, reason why:  
 Recommended pumping rate:  
 Liters/Min  
 Recommended pump intake: M  
 Type pump installed  
 Pump type:  
 Pump model:  
 H.P.:  
 Any further pumptest information?

## 4. Formation Log

Depth  
 from  
 ground  
 level  
 (meters)  
 Lithology Description

## 5. Well Completion

Date Started(yyyy/mm/dd): Date Completed  
 (yyyy/mm/dd):  
 1950/01/01  
 Well Depth: 15.24 M Borehole Diameter: 0 CM  
 Casing Type: Liner Type:  
 Size OD: 0 CM Size OD: 0 CM  
 Wall Thickness: 0 CM Wall Thickness: 0 CM  
 Bottom at: 0 M Top: 0 M Bottom: 0 M  
 Perforations Perforations Size:  
 from: 0 M to: 0 M 0 CM x 0 CM  
 from: 0 M to: 0 M 0 CM x 0 CM  
 from: 0 M to: 0 M 0 CM x 0 CM  
 Perforated by:  
 Seal:  
 from: 0 M to: 0 M  
 Seal:  
 from: 0 M to: 0 M  
 Seal:  
 from: 0 M to: 0 M  
 Screen Type: Screen ID: 0 CM  
 from: 0 M to: 0 M Slot Size: 0 CM  
 Screen Type: Screen ID: 0 CM  
 from: 0 M to: 0 M Slot Size: 0 CM  
 Screen Installation Method:  
 Fittings  
 Top: Bottom:  
 Pack:  
 Grain Size: Amount:  
 Geophysical Log Taken:  
 Retained on Files:  
 Additional Test and/or Pump Data  
 Chemistries taken By Driller: Yes  
 Held: 1 Documents Held: 2  
 Pitless Adapter Type:  
 Drop Pipe Type:  
 Length: Diameter:  
 Comments:  
 OWNER REPORTS SOFT WATER.

## 7. Contractor Certification

Driller's Name: UNKNOWN DRILLER  
 Certification No.:  
 This well was constructed in accordance with the Water

Well regulation of the Alberta Environmental Protection  
& Enhancement Act. All information in this report is true.  
Signature Yr Mo Day

Report 1



# Water Well Drilling Report

The data contained in this report is supplied by the Driller. The province disclaims responsibility for its accuracy.

Well I.D.: 0341921  
 Map Verified: Map  
 Date Report: 2002/12/13  
 Received:  
 Measurements: Metric

<b>1. Contractor &amp; Well Owner Information</b>			<b>2. Well Location</b>		
Company Name: ALKEN BASIN DRILLING LTD.		Drilling Company Approval No.: 38394	1/4 or Sec Twp Rge Westof LSD M		
Mailing Address: BOX 47		City or Town: BENTLEY AB CANADA	10 01 041 01 5		
WellOwner's Name: SANDY POINT FARMS		Well Location Identifier:	Location in Quarter 0 M from Boundary 0 M from Boundary		
P.O. Box Number: 119		Mailing Address: BENTLEY	Lot Block Plan		
City:		Province:	Well Elev: M		
		Country:	How Obtain: Not Obtain		
<b>3. Drilling Information</b>			<b>6. Well Yield</b>		
Type of Work: New Well		Proposed well use:	Test Date Start Time:		
Reclaimed Well		Stock	(yyyy/mm/dd):		
Date Reclaimed:		Anticipated Water	2002/11/20 11:00 AM		
Method of Drilling: Rotary		Requirements/day	Test Method: Air		
Flowing Well: No		Rate: Liters	Non pumping 6.71 M		
Gas Present: No		Oil Present: No	static level:		
<b>4. Formation Log</b>		<b>5. Well Completion</b>		Rate of water removal: 227.3 Liters/Min	
Depth from ground level (meters)		Date Started(yyyy/mm/dd): 2002/11/20		Depth of pump intake: 54.86 M	
<b>Lithology Description</b>		Date Completed (yyyy/mm/dd): 2002/11/20		Water level at end of pumping: 19.81 M	
3.66 Clay		Well Depth: 54.86 M		Distance from top of CM casing to ground level:	
10.67 Brown Shale		Casing Type: Steel		Depth To water level (meters) Elapsed Time	
12.8 Brown Sandstone		Liner Type: Plastic		Drawdown Minutes:Sec Recovery	
15.24 Gray Sandstone		Size OD: 21.89 CM		15.4 1:00 10.1	
21.34 Gray Shale		Wall Thickness: 0.93 CM		17.5 2:00 8	
24.08 Gray Sandstone		Bottom at: 31.7 M		18.42 3:00 7.81	
32.31 Gray Shale		Top: 24.38 M Bottom: 54.86 M		18.63 4:00 7.77	
51.82 Gray Sandstone		Perforations from: 36.58 M to: 48.77 M		19.05 5:00 7.74	
54.86 Gray Shale		Perforations Size: 1.27 CM x 1.27 CM		19.32 6:00 7.72	
		Perforations from: 0 M to: 0 M		19.41 7:00 7.71	
		Perforations from: 0 M to: 0 M		19.52 8:00 7.7	
		Perforated by: Hand Drill		19.62 9:00 7.69	
		Seal: Driven & Bentonite		19.69 10:00 7.68	
		from: 0 M to: 31.7 M		19.8 12:00 7.66	
		Seal:		19.92 14:00 7.65	
		from: 0 M to: 0 M		19.84 16:00 7.64	
		Seal:		19.88 20:00 7.63	
		from: 0 M to: 0 M		19.75 25:00 7.62	
		Screen Type: Screen ID: 0 CM		19.74 30:00 7.62	
		from: 0 M to: 0 M Slot Size: 0 CM		19.72 35:00 7.61	
		Screen Type: Screen ID: 0 CM		19.72 40:00 7.6	
		from: 0 M to: 0 M Slot Size: 0 CM		19.77 50:00 7.59	
		Screen Installation Method:		19.82 60:00 7.57	
		Fittings		19.87 75:00 7.56	
		Top: Bottom:		19.92 90:00 7.54	
		Pack:		19.93 105:00 7.52	
		Grain Size: Amount:		19.95 120:00 7.5	
		Geophysical Log Taken:		Total Drawdown: 13.11 M	
		Retained on Files:		If water removal was less than 2 hr duration, reason why:	
		Additional Test and/or Pump Data		Recommended pumping rate: 227.3 Liters/Min	
		Chemistries taken By Driller: No		Recommended pump intake: 48.77 M	
		Held: 0 Documents Held: 1		Type Pump Installed	
		Pitless Adapter Type:		Pump Type:	
		Drop Pipe Type:			
		Length: M Diameter: CM			
		Comments:			
<b>7. Contractor Certification</b>					
Driller's Name:		UNKNOWN DRILLER			
Certification No.:		12389Q			
This well was constructed in accordance with the Water					

Well regulation of the Alberta Environmental Protection & Enhancement Act. All information in this report is true.		Pump Model:
Signature	Yr Mo Day	H.P.: Any further pump test information?

**Report 1 Pump Test 1 page1**





# Water Well Drilling Report

The data contained in this report is supplied by the Driller. The province disclaims responsibility for its accuracy.

Well I.D.: 0341922  
 Map Verified: Map  
 Date Report: 2002/12/11  
 Received:  
 Measurements: Metric

## 1. Contractor & Well Owner Information

Company Name: ALKEN BASIN DRILLING LTD. Drilling Company Approval No.: 38394  
 Mailing Address: BOX 47 City or Town: BENTLEY AB CANADA Postal Code: T0C 0J0  
 Well Owner's Name: SANDY POINT FARMS Well Location Identifier:  
 P.O. Box Number: 119 Mailing Address: BENTLEY Postal Code: T0C 0J0  
 City: Province: Country:

## 2. Well Location

1/4 or Sec Twp Rge West of  
 LSD 10 01 041 01 M  
 Location in Quarter  
 0 M from Boundary  
 0 M from Boundary  
 Lot Block Plan  
 Well Elev: M How Obtain: Not Obtain

## 3. Drilling Information

Type of Work: New Well Proposed well use: Stock  
 Reclaimed Well Anticipated Water Requirements/day  
 Date Reclaimed: Materials Used: 0 Liters  
 Method of Drilling: Rotary  
 Flowing Well: No Rate: Liters  
 Gas Present: No Oil Present: No

## 6. Well Yield

Test Date: 2002/11/13 Start Time: 11:00 AM  
 Test Method: Air  
 Non pumping static level: 7.32 M

## 4. Formation Log

Depth from ground level (meters)  
**Lithology Description**  
 4.27 Brown Clay  
 7.32 Brown Sandstone  
 10.97 Brown Shale  
 11.89 Gray Shale  
 13.72 Gray Sandstone  
 14.63 Gray Shale  
 17.68 Gray Sandstone  
 21.95 Gray Shale  
 24.69 Gray Sandstone  
 32.61 Gray Shale  
 51.82 Gray Sandstone  
 54.86 Gray Shale

## 5. Well Completion

Date Started (yyyy/mm/dd): 2002/11/13 Date Completed (yyyy/mm/dd): 2002/11/13  
 Well Depth: 54.86 M Borehole Diameter: 0 CM  
 Casing Type: Steel Liner Type: Plastic  
 Size OD: 14.12 CM Size OD: 11.43 CM  
 Wall Thickness: 0.66 CM Wall Thickness: 0.54 CM  
 Bottom at: 29.57 M Top: 24.38 M Bottom: 54.86 M  
 Perforations from: 36.58 M to: 51.82 M Perforations Size: 1.27 CM x 1.27 CM  
 from: 0 M to: 0 M 0 CM x 0 CM  
 from: 0 M to: 0 M 0 CM x 0 CM  
 Perforated by: Hand Drill  
 Seal: Driven & Bentonite  
 from: 0 M to: 29.57 M  
 Seal:  
 from: 0 M to: 0 M  
 Seal:  
 from: 0 M to: 0 M  
 Screen Type: Screen ID: 0 CM  
 from: 0 M to: 0 M Slot Size: 0 CM  
 Screen Type: Screen ID: 0 CM  
 from: 0 M to: 0 M Slot Size: 0 CM  
 Screen Installation Method:  
 Fittings  
 Top: Bottom:  
 Pack:  
 Grain Size: Amount:  
 Geophysical Log Taken:  
 Retained on Files:  
 Additional Test and/or Pump Data  
 Chemistries taken By Driller: No  
 Held: 0 Documents Held: 1  
 Pitless Adapter Type:  
 Drop Pipe Type:  
 Length: M Diameter: CM  
 Comments:

Rate of water removal: 227.3 Liters/Min  
 Depth of pump intake: 54.86 M  
 Water level at end of pumping: 19.81 M  
 Distance from top of CM casing to ground level:  
 Depth To water level (meters)  
 Elapsed Time  
 Drawdown Minutes: Sec Recovery  
 15.4 1:00 10.1  
 17.5 2:00 8  
 18.42 3:00 7.81  
 18.63 4:00 7.77  
 19.05 5:00 7.74  
 19.32 6:00 7.72  
 19.42 7:00 7.71  
 19.51 8:00 7.7  
 19.61 9:00 7.69  
 19.68 10:00 7.68  
 19.9 14:00 7.65  
 19.87 20:00 7.63  
 19.76 25:00 7.62  
 19.67 30:00 7.62  
 19.7 40:00 7.6  
 19.75 50:00 7.59  
 19.8 60:00 7.57  
 19.85 75:00 7.56  
 19.9 90:00 7.55  
 19.93 120:00 7.54

Total Drawdown: 12.5 M

If water removal was less than 2 hr duration, reason why:

Recommended pumping rate: 227.3 Liters/Min

Recommended pump intake: 51.82 M

Type Pump Installed

Pump Type:

Pump Model:

H.P.:

Any further pump test information?

## 7. Contractor Certification

Driller's Name: UNKNOWN DRILLER  
 Certification No.: VA3129  
 This well was constructed in accordance with the Water



Well regulation of the Alberta Environmental Protection  
& Enhancement Act. All information in this report is true.  
Signature Yr Mo Day

Report 1 Pump Test 1 page1



# Water Well Drilling Report

The data contained in this report is supplied by the Driller. The province disclaims responsibility for its accuracy.

Well I.D.: 0354465  
 Map Verified: Map  
 Date Report: 1989/02/10  
 Received:  
 Measurements: Metric

## 1. Contractor & Well Owner Information

Company Name: UNKNOWN DRILLER Drilling Company Approval No.: 99999  
 Mailing Address: UNKNOWN City or Town: UNKNOWN AB CA Postal Code:  
 Well Owner's Name: NORVIA, P. Well Location Identifier:  
 P.O. Box Number: 131 Mailing Address: BENTLEY Postal Code: T0C 0J0  
 City: Province: Country:

## 2. Well Location

1/4 or Sec Twp Rge West of  
 LSD M  
 NW 12 041 01 5  
 Location in Quarter  
 0 M from Boundary  
 0 M from Boundary  
 Lot Block Plan  
 Well Elev: M How Obtain: Not Obtain

## 3. Drilling Information

Type of Work: Chemistry  
 Reclaimed Well  
 Date Reclaimed: Materials Used:  
 Method of Drilling: Not Applicable  
 Flowing Well: No Rate: Liters  
 Gas Present: Oil Present:

## 6. Well Yield

Test Date Start Time:  
 (yyyy/mm/dd):  
 Test Method:  
 Non pumping M  
 static level:

## 4. Formation Log

Depth from ground level (meters)  
 Lithology Description

## 5. Well Completion

Date Started (yyyy/mm/dd): Date Completed (yyyy/mm/dd):  
 Well Depth: 38.1 M Borehole Diameter: 0 CM  
 Casing Type: Liner Type:  
 Size OD: 0 CM Size OD: 0 CM  
 Wall Thickness: 0 CM Wall Thickness: 0 CM  
 Bottom at: 0 M Top: 0 M Bottom: 0 M  
 Perforations from: 0 M to: 0 M Perforations Size: 0 CM x 0 CM  
 from: 0 M to: 0 M 0 CM x 0 CM  
 from: 0 M to: 0 M 0 CM x 0 CM  
 Perforated by:  
 Seal: from: 0 M to: 0 M  
 Seal: from: 0 M to: 0 M  
 Seal: from: 0 M to: 0 M  
 Screen Type: Screen ID: 0 CM  
 from: 0 M to: 0 M Slot Size: 0 CM  
 Screen Type: Screen ID: 0 CM  
 from: 0 M to: 0 M Slot Size: 0 CM  
 Screen Installation Method:  
 Fittings Top: Bottom:  
 Pack: Grain Size: Amount: 0  
 Geophysical Log Taken:  
 Retained on Files:  
 Additional Test and/or Pump Data  
 Chemistries taken By Driller: No  
 Held: 3 Documents Held: 3  
 Pitless Adapter Type:  
 Drop Pipe Type: Length: Diameter:  
 Comments:

Rate of water removal: Liters/Min  
 Depth of pump intake: M  
 Water level at M end of pumping:  
 Distance from CM top of casing to ground level:

Depth To water level (meters)  
 Elapsed Time  
 Drawdown Minutes: Sec Recovery

Total Drawdown: M  
 If water removal was less than 2 hr duration, reason why:

Recommended pumping rate: Liters/Min  
 Recommended pump intake: M

Type pump installed  
 Pump type:  
 Pump model:  
 H.P.:  
 Any further pumptest information?

## 7. Contractor Certification

Driller's Name: UNKNOWN DRILLER  
 Certification No.:  
 This well was constructed in accordance with the Water

Well regulation of the Alberta Environmental Protection & Enhancement Act. All information in this report is true.	
Signature	Yr Mo Day

Report 1

**Appendix 5: Abacus Datagraphics Ltd. Record Search**



# Map2

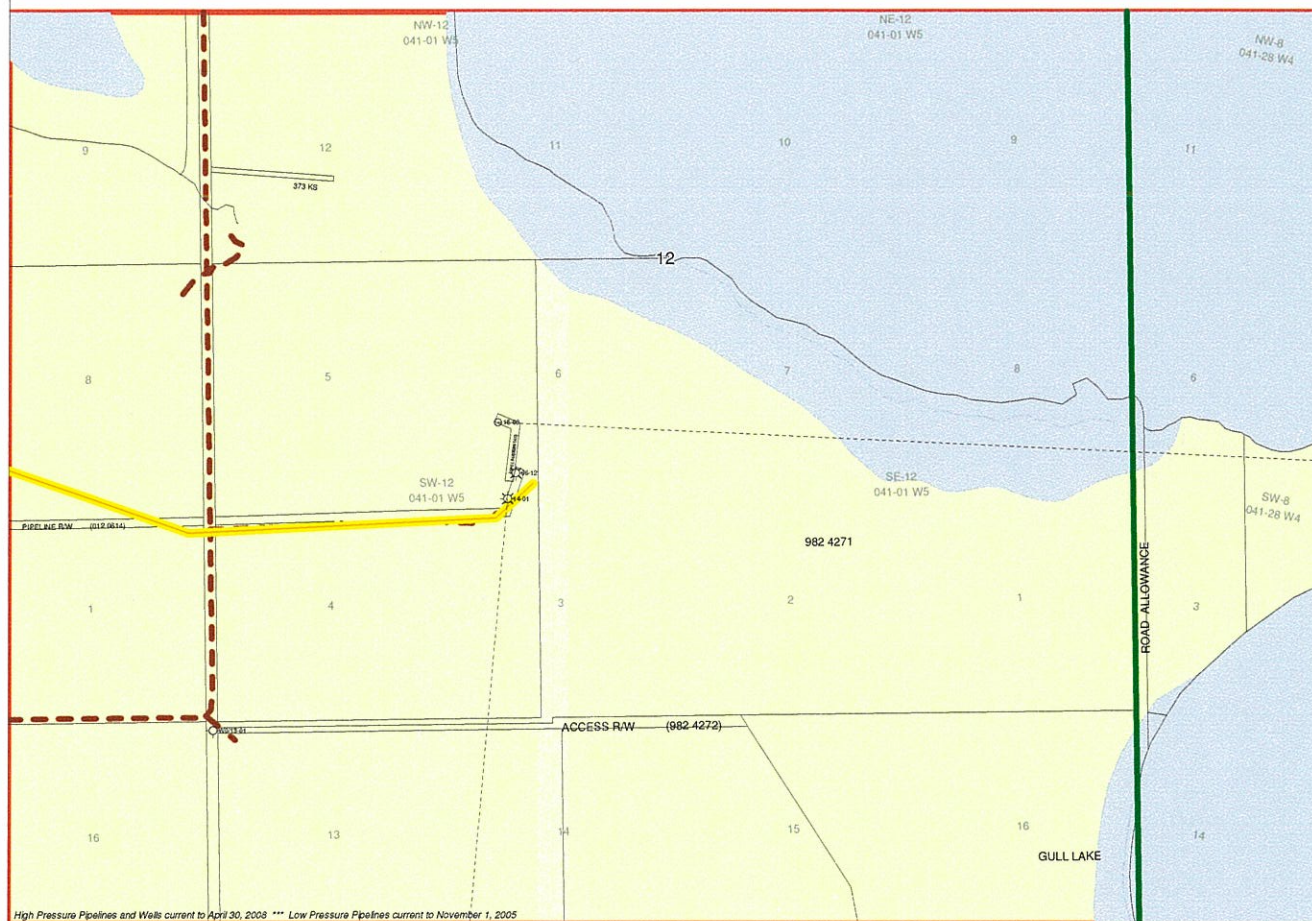

High Pressure Pipelines and Wells current to April 30, 2008 \*\*\*\* Low Pressure Pipelines current to November 1, 2005

## Wellheads

- Abandoned Wellhead
- Suspended Gas Wellhead
- Suspended Oil Wellhead
- ✱ Flowing Gas Wellhead
- Location Wellhead
- Flowing Oil Wellhead
- ✱ Miscellaneous Wellhead
- ✱ Water Wellhead
- ✱ Well Downhole Location
- Newly Licenced Well
- Newly Spudded Well

## High Pressure Pipelines

- Gas Pipeline
- Oil Pipeline
- Water Pipeline
- LVP/HVP Pipeline
- Foreign Pipeline (Only when a company is specified.)

## Low Pressure Pipelines

- Gas Co-op Pipeline

EUB DATA		ATTACHED FILES		Close Screen	
<b>EUB PIPELINE INFORMATION</b> CURRENT TO APRIL 30, 2008					
LICENCE/LINE #:	24658 - 10	PERMIT DATE:	OCTOBER 20, 2000		
ABACUS #:	30592	LICENCE DATE:	APRIL 20, 2001		
COMPANY:	PROVIDENT ENERGY LTD.				
FROM LOCATION:	06-12-041-01 W5M WE	TO LOCATION:	07-10-041-01 W5M PL		
LENGTH:	3.18 kms	1.98 mi	STATUS:	O	
SUBSTANCE:	NG	H2S:	0 mol/kmol	0 ppm	
OD:	114.3 mm	4.50 "	WT:	3.96 mm	0.16 "
MATERIAL:	S	TYPE:	Z245.1		
GRADE:	3591	MOP:	9900 kPa	1436 psi	
JOINTS:	W	INTL COATING:	U		
STRESS LEVEL:	40 %	ENVIRONMENT:			
ORIGINAL PERMIT DATE:	OCTOBER 20, 2000	CONST. DATE:			
ORIGINAL LICENCE/LINE #:	24658 - 10				
<div><b>OPTIONS</b>  <a href="#">View Company Info</a>  <a href="#">View Installation Info</a>  <a href="#">View Entire Licence</a>  <a href="#">View Licence Ticket</a>  <a href="#">View Spill Incidents</a>  <a href="#">Highlight Line</a>  <a href="#">Highlight Entire Licence</a>  <a href="#">Print Screen</a></div>					

[PRINT REPORT](#)[VIEW IN EXCEL](#)[CLOSE REPORT](#)

<b>LOCATION: 01-12-041-01W5M</b>
There are no Spill/Complaint Incidents for this LSD.
<b>LOCATION: 02-12-041-01W5M</b>
There are no Spill/Complaint Incidents for this LSD.
<b>LOCATION: 03-12-041-01W5M</b>
There are no Spill/Complaint Incidents for this LSD.
<b>LOCATION: 04-12-041-01W5M</b>
There are no Spill/Complaint Incidents for this LSD.
<b>LOCATION: 05-12-041-01W5M</b>
There are no Spill/Complaint Incidents for this LSD.
<b>LOCATION: 06-12-041-01W5M</b>
There are no Spill/Complaint Incidents for this LSD.
<b>LOCATION: 07-12-041-01W5M</b>
There are no Spill/Complaint Incidents for this LSD.
<b>LOCATION: 08-12-041-01W5M</b>
There are no Spill/Complaint Incidents for this LSD.



PRINT REPORT

VIEW IN EXCEL

CLOSE REPORT

<b>WELL ID:</b>	00 / 15-08-041-28 W4 / 2		
<b>LICENCE #:</b>	0360907	<b>LICENCE DATE:</b>	JULY 27, 2006
<b>WELL NAME:</b>	CABRERRA ET AL MORNSIDE 15-8-41-28		
<b>WITHIN:</b>	06-12-041-01 W5	<b>H2S (mol/kmol):</b>	NOT AVAILABLE
<b>LICENCEE:</b>	CABRERRA RESOURCES LTD.		
<b>SPUD DATE:</b>	SEPTEMBER 20, 2006	<b>FINAL DRILL DATE:</b>	SEPTEMBER 30, 2006
<b>STATUS:</b>	COMM	<b>ABANDONED DATE:</b>	
<b>SURFACE:</b>	<b>DOWNHOLE:</b>		
<b>OFFSETS:</b>	N 520 E 497	<b>OFFSETS:</b>	N 520 E 497
<b>LATITUDE:</b>	52.513397	<b>LATITUDE:</b>	52.512504
<b>LONGITUDE:</b>	114.018366	<b>LONGITUDE:</b>	113.994327
<b>GROUND ELEVATION:</b>	907.7 m	<b>TOTAL DEPTH:</b>	2637 m
<b>WELL TYPE:</b>	NOT AVAILABLE	<b>SUBSTANCE:</b>	NOT AVAILABLE

<b>WELL ID:</b>	W0 / 13-01-041-01 W5 / 0	RecExempt	
<b>LICENCE #:</b>	0006991Y	<b>LICENCE DATE:</b>	SEPTEMBER 2, 1953
<b>WELL NAME:</b>	CALIFORNIA 177 RIMBEY TH 13-1-41-1		
<b>WITHIN:</b>	13-01-041-01 W5	<b>H2S (mol/kmol):</b>	NOT AVAILABLE
<b>LICENCEE:</b>	CHEVRON CANADA LIMITED		
<b>SPUD DATE:</b>	SEPTEMBER 2, 1953	<b>FINAL DRILL DATE:</b>	SEPTEMBER 2, 1953
<b>STATUS:</b>	ABD	<b>ABANDONED DATE:</b>	SEPTEMBER 3, 1953
<b>SURFACE:</b>	<b>DOWNHOLE:</b>		
<b>OFFSETS:</b>	S 15.5 W 1618.4	<b>OFFSETS:</b>	S 15.5 W 1618.4
<b>LATITUDE:</b>	52.508592	<b>LATITUDE:</b>	52.508592
<b>LONGITUDE:</b>	114.025804	<b>LONGITUDE:</b>	114.025804
<b>GROUND ELEVATION:</b>	933.7 m	<b>TOTAL DEPTH:</b>	330 m
<b>WELL TYPE:</b>	NOT AVAILABLE	<b>SUBSTANCE:</b>	NOT AVAILABLE

<b>WELL ID:</b>	00 / 14-01-041-01 W5 / 3		
<b>LICENCE #:</b>	0241276	<b>LICENCE DATE:</b>	AUGUST 23, 2000
<b>WELL NAME:</b>	PROVIDENT GILBY 14-1-41-1		
<b>WITHIN:</b>	03-12-041-01 W5	<b>H2S (mol/kmol):</b>	NOT AVAILABLE
<b>LICENCEE:</b>	PROGRESS ENERGY LTD.		
<b>SPUD DATE:</b>	OCTOBER 2, 2000	<b>FINAL DRILL DATE:</b>	OCTOBER 14, 2000
<b>STATUS:</b>	GAS FLOW	<b>ABANDONED DATE:</b>	
<b>SURFACE:</b>	<b>DOWNHOLE:</b>		
<b>OFFSETS:</b>	N 385 E 511.9	<b>OFFSETS:</b>	S 380.6 E 434.3
<b>LATITUDE:</b>	52.512187	<b>LATITUDE:</b>	52.505303
<b>LONGITUDE:</b>	114.01814	<b>LONGITUDE:</b>	114.019281
<b>GROUND ELEVATION:</b>	908.8 m	<b>TOTAL DEPTH:</b>	2142 m
<b>WELL TYPE:</b>	NOT AVAILABLE	<b>SUBSTANCE:</b>	NOT AVAILABLE

<b>WELL ID:</b>	00 / 06-12-041-01 W5 / 0		
<b>LICENCE #:</b>	0240963	<b>LICENCE DATE:</b>	AUGUST 16, 2000
<b>WELL NAME:</b>	PROVIDENT GILBY 6-12-41-1 W5		
<b>WITHIN:</b>	06-12-041-01 W5	<b>H2S (mol/kmol):</b>	NOT AVAILABLE
<b>LICENCEE:</b>	PROVIDENT ENERGY LTD.		
<b>SPUD DATE:</b>	AUGUST 24, 2000	<b>FINAL DRILL DATE:</b>	AUGUST 26, 2000
<b>STATUS:</b>	GAS FLOW	<b>ABANDONED DATE:</b>	
<b>SURFACE:</b>	<b>DOWNHOLE:</b>		
<b>OFFSETS:</b>	N 430 E 526.9	<b>OFFSETS:</b>	N 430 E 526.9
<b>LATITUDE:</b>	52.512592	<b>LATITUDE:</b>	52.512592
<b>LONGITUDE:</b>	114.017919	<b>LONGITUDE:</b>	114.017919



GROUND ELEVATION:	907.4 m	TOTAL DEPTH:	1939 m
WELL TYPE:	NOT AVAILABLE	SUBSTANCE:	NOT AVAILABLE

*EUB WELL INFORMATION CURRENT TO JUNE 2, 2008*

CLOSE REPORT

There are no Facilities found.

[PRINT REPORT](#)[VIEW IN EXCEL](#)[CLOSE REPORT](#)

<b>LOCATION: 01-08-041-28W4M</b>
There are no Spill/Complaint Incidents for this LSD.
<b>LOCATION: 02-08-041-28W4M</b>
There are no Spill/Complaint Incidents for this LSD.
<b>LOCATION: 03-08-041-28W4M</b>
There are no Spill/Complaint Incidents for this LSD.
<b>LOCATION: 04-08-041-28W4M</b>
There are no Spill/Complaint Incidents for this LSD.
<b>LOCATION: 05-08-041-28W4M</b>
There are no Spill/Complaint Incidents for this LSD.
<b>LOCATION: 06-08-041-28W4M</b>
There are no Spill/Complaint Incidents for this LSD.
<b>LOCATION: 07-08-041-28W4M</b>
There are no Spill/Complaint Incidents for this LSD.
<b>LOCATION: 08-08-041-28W4M</b>
There are no Spill/Complaint Incidents for this LSD.
<b>LOCATION: 09-01-041-01W5M</b>
There are no Spill/Complaint Incidents for this LSD.
<b>LOCATION: 10-01-041-01W5M</b>
There are no Spill/Complaint Incidents for this LSD.
<b>LOCATION: 11-01-041-01W5M</b>
There are no Spill/Complaint Incidents for this LSD.
<b>LOCATION: 12-01-041-01W5M</b>
There are no Spill/Complaint Incidents for this LSD.
<b>LOCATION: 13-01-041-01W5M</b>
There are no Spill/Complaint Incidents for this LSD.
<b>LOCATION: 14-01-041-01W5M</b>
There are no Spill/Complaint Incidents for this LSD.
<b>LOCATION: 15-01-041-01W5M</b>
There are no Spill/Complaint Incidents for this LSD.

<b>LOCATION: 16-01-041-01W5M</b>
There are no Spill/Complaint Incidents for this LSD.
<b>LOCATION: 01-11-041-01W5M</b>
There are no Spill/Complaint Incidents for this LSD.
<b>LOCATION: 02-11-041-01W5M</b>
There are no Spill/Complaint Incidents for this LSD.
<b>LOCATION: 07-11-041-01W5M</b>
There are no Spill/Complaint Incidents for this LSD.
<b>LOCATION: 08-11-041-01W5M</b>
There are no Spill/Complaint Incidents for this LSD.
<b>LOCATION: 09-12-041-01W5M</b>
There are no Spill/Complaint Incidents for this LSD.
<b>LOCATION: 10-12-041-01W5M</b>
There are no Spill/Complaint Incidents for this LSD.
<b>LOCATION: 11-12-041-01W5M</b>
There are no Spill/Complaint Incidents for this LSD.
<b>LOCATION: 12-12-041-01W5M</b>
There are no Spill/Complaint Incidents for this LSD.
<b>LOCATION: 13-12-041-01W5M</b>
There are no Spill/Complaint Incidents for this LSD.
<b>LOCATION: 14-12-041-01W5M</b>
There are no Spill/Complaint Incidents for this LSD.
<b>LOCATION: 15-12-041-01W5M</b>
There are no Spill/Complaint Incidents for this LSD.
<b>LOCATION: 16-12-041-01W5M</b>
There are no Spill/Complaint Incidents for this LSD.



[PRINT REPORT](#)
[VIEW IN EXCEL](#)
[CLOSE REPORT](#)

<b>WELL ID:</b>	00 / 15-08-041-28 W4 / 2		
<b>LICENCE #:</b>	0360907	<b>LICENCE DATE:</b>	JULY 27, 2006
<b>WELL NAME:</b>	CABRERRA ET AL MORNSIDE 15-8-41-28		
<b>WITHIN:</b>	06-12-041-01 W5	<b>H2S (mol/kmol):</b>	NOT AVAILABLE
<b>LICENCEE:</b>	CABRERRA RESOURCES LTD.		
<b>SPUD DATE:</b>	SEPTEMBER 20, 2006	<b>FINAL DRILL DATE:</b>	SEPTEMBER 30, 2006
<b>STATUS:</b>	COMM	<b>ABANDONED DATE:</b>	
<b>SURFACE:</b>	<b>DOWNHOLE:</b>		
<b>OFFSETS:</b>	N 520 E 497	<b>OFFSETS:</b>	N 520 E 497
<b>LATITUDE:</b>	52.513397	<b>LATITUDE:</b>	52.512504
<b>LONGITUDE:</b>	114.018366	<b>LONGITUDE:</b>	113.994327
<b>GROUND ELEVATION:</b>	907.7 m	<b>TOTAL DEPTH:</b>	2637 m
<b>WELL TYPE:</b>	NOT AVAILABLE	<b>SUBSTANCE:</b>	NOT AVAILABLE

<b>WELL ID:</b>	W0 / 13-01-041-01 W5 / 0	RecExempt	
<b>LICENCE #:</b>	0006991Y	<b>LICENCE DATE:</b>	SEPTEMBER 2, 1953
<b>WELL NAME:</b>	CALIFORNIA 177 RIMBEY TH 13-1-41-1		
<b>WITHIN:</b>	13-01-041-01 W5	<b>H2S (mol/kmol):</b>	NOT AVAILABLE
<b>LICENCEE:</b>	CHEVRON CANADA LIMITED		
<b>SPUD DATE:</b>	SEPTEMBER 2, 1953	<b>FINAL DRILL DATE:</b>	SEPTEMBER 2, 1953
<b>STATUS:</b>	ABD	<b>ABANDONED DATE:</b>	SEPTEMBER 3, 1953
<b>SURFACE:</b>	<b>DOWNHOLE:</b>		
<b>OFFSETS:</b>	S 15.5 W 1618.4	<b>OFFSETS:</b>	S 15.5 W 1618.4
<b>LATITUDE:</b>	52.508592	<b>LATITUDE:</b>	52.508592
<b>LONGITUDE:</b>	114.025804	<b>LONGITUDE:</b>	114.025804
<b>GROUND ELEVATION:</b>	933.7 m	<b>TOTAL DEPTH:</b>	330 m
<b>WELL TYPE:</b>	NOT AVAILABLE	<b>SUBSTANCE:</b>	NOT AVAILABLE

<b>WELL ID:</b>	00 / 14-01-041-01 W5 / 3		
<b>LICENCE #:</b>	0241276	<b>LICENCE DATE:</b>	AUGUST 23, 2000
<b>WELL NAME:</b>	PROVIDENT GILBY 14-1-41-1		
<b>WITHIN:</b>	03-12-041-01 W5	<b>H2S (mol/kmol):</b>	NOT AVAILABLE
<b>LICENCEE:</b>	PROGRESS ENERGY LTD.		
<b>SPUD DATE:</b>	OCTOBER 2, 2000	<b>FINAL DRILL DATE:</b>	OCTOBER 14, 2000
<b>STATUS:</b>	GAS FLOW	<b>ABANDONED DATE:</b>	
<b>SURFACE:</b>	<b>DOWNHOLE:</b>		
<b>OFFSETS:</b>	N 385 E 511.9	<b>OFFSETS:</b>	S 380.6 E 434.3
<b>LATITUDE:</b>	52.512187	<b>LATITUDE:</b>	52.505303
<b>LONGITUDE:</b>	114.01814	<b>LONGITUDE:</b>	114.019281
<b>GROUND ELEVATION:</b>	908.8 m	<b>TOTAL DEPTH:</b>	2142 m
<b>WELL TYPE:</b>	NOT AVAILABLE	<b>SUBSTANCE:</b>	NOT AVAILABLE

EUB WELL INFORMATION CURRENT TO JUNE 2, 2008

EUB DATA		ATTACHED FILES		Close Screen	
<b>EUB PIPELINE INFORMATION CURRENT TO APRIL 30, 2008</b>					
LICENCE/LINE #:	24658 - 10	PERMIT DATE:	OCTOBER 20, 2000		
ABACUS #:	30592	LICENCE DATE:	APRIL 20, 2001		
COMPANY:	PROVIDENT ENERGY LTD.				
FROM LOCATION:	06-12-041-01 W5M WE	TO LOCATION:	07-10-041-01 W5M PL		
LENGTH:	3.18 kms	1.98 mi	STATUS:	O	
SUBSTANCE:	NG	H2S:	0 mol/kmol	0 ppm	
OD:	114.3 mm	4.50 "	WT:	3.96 mm	0.16 "
MATERIAL:	S	TYPE:	Z245.1		
GRADE:	3591	MOP:	9900 kPa	1436 psi	
JOINTS:	W	INTL COATING:	U		
STRESS LEVEL:	40 %	ENVIRONMENT:			
ORIGINAL PERMIT DATE:	OCTOBER 20, 2000	CONST. DATE:			
ORIGINAL LICENCE/LINE #:	24658 - 10				
<b>OPTIONS</b>					
<a href="#">View Company Info</a>					
<a href="#">View Installation Info</a>					
<a href="#">View Entire Licence</a>					
<a href="#">View Licence Ticket</a>					
<a href="#">View Spill Incidents</a>					
<a href="#">Highlight Line</a>					
<a href="#">Highlight Entire Licence</a>					
<a href="#">Print Screen</a>					

PRINT REPORT

VIEW IN EXCEL

CLOSE REPORT

There are no Facilities found.

Appendix 6: Disclosure Statements



No data is available for this section.

## Appendix 7: Past Environmental Reports

## Appendix 8: Qualifications and Information Pertaining to the Environmental Consultants

**Name of Firm:** Ecomark Ltd.

**Address:** 100 – 14964 – 121A Avenue, Edmonton, Alberta T5V 1A3

**Phone:** (780) 444-0706

**Fax:** 1-866-337-8631

**Date Established:** January 11, 2000

**Insurance Coverage:**

- ❖ Professional Errors & Omissions - \$2,000,000
- ❖ Commercial General Liability - \$1,000,000
- ❖ WCB Account

**Safety Training:** All professional staff at Ecomark has appropriate safety training in WHIMS, H<sub>2</sub>S Alive, TDG, First Aid and Ground Disturbance Practices.

We excel in assessments, reclamation and remediation, and corporate environmental management. Our experience covers phase 1, 2, and 3 environmental assessments and environmental audits on the widest variety of industrial/commercial and residential properties and companies. We also have extensive facility experience, from scouting potential routes and facilities, through audit of existing facilities, to final reclamation and restoration of disturbed habitats.

One of our key strengths is corporate (government) liability assessments. We evaluate the environmental liability incumbent to a site or sites. We have been relied on by major corporations to place a monetary value on the environmental liability of assets being acquired, disposed of, or maintained.

Our staff provides Ecomark with 28 years of individual professional experience. We have appropriate professional errors and omission (E&O) insurance, contractors general liability (CGL) insurance, and Worker's Compensation. We have also attained Small Employer Certificate of Recognition (SECOR) safety status. A professional biologist, professional chemist, professional engineer, or professional geologist warrants all our work. We do quality, fully warranted assessments that all parties can understand.

## **Ecomark Ltd. Projects and Experience**

### **Phase 1 Environmental Assessments**

Phase 1 environmental assessments throughout Canada

### **Phase 2 Environmental Assessments**

Phase 2 environmental assessments throughout Canada

Tier 2 risk assessments, Airdrie, Sundre, and North Garrington, Alberta

### **Phase 3 and 4 Environmental Assessments**

Oilfields reclamation in Devon, Bonnie Glen and Redwater

Oil lease cleanups

Class 3 railway derailment cleanup and complete railway line abandonment

Diesel spill remediation

Fuel tank removals and cleanups

Underground storage tank remediation

Contaminated soil cleanups

Landfill reclamations

Salt spill weeping tile design and geotechnical assessment

Bioremediation, audit, waste cleanup, and process redesign

Erith River crossings reclamation

Peat bog sewage treatment field reclamation

Grading, cleanup, and reclamation of Mountain Park Loop

Pipeline crossing inspection, creek monitoring, and reclamation

Native grass and forbs species research for boreal forest reclamation

Stabilization of a mineral spring

Mitigation measures and further recommendations for rare native grasslands

Constructed wetland, survey, plan, construction

Wastewater tertiary treatment

### **Mould Assessments**

Mould assessments

Indoor air quality assessments

### **Assessments – Reports, Acquisition, Habitat, Hazard, Environmental Impact and Others**

Corporate environmental acquisition assessments

Chemical/brownfield site assessments

Federal and provincial environmental impact assessments

Health risk impact assessment, Health Board equivalent of an EIA

Environmental compliance audit for health facilities

Commercial environmental audits and technical reviews

Hazard identification assessments for industry, developers, and municipalities

Complete biophysical assessments, including wetland and aquatic assessments Compost research and field application trials

Nutrient management in intensive livestock operations

Effects on nitrogen leaching in soils with the application of bedding

Effects of phosphogypsum on compost

Waste operations

Route selection and design of river crossings for pipelines

Technology evaluations for secondary off-gas treatment, cement kiln

Scouting, application, and approvals for linear development projects

Medicine Lodge Loop environmental assessment

Environmental field report for Cheviot and Mountain Park Railway

Stormwater outflow inspection and installation, Atim Creek

Culvert installation under Atim Creek CN Right-Of-Way

Aquatic inspection in Athabasca and North Saskatchewan drainages



Fisheries monitoring studies and research and creek fisheries assessments  
Transalta fish recovery tank for Lake Wabamun  
Dredging impact literature search and sediment survey, Lake Wabamun  
Rare plant studies throughout western Canada, including a study covering 1.8 million hectares in northwestern Saskatchewan, and smaller studies in BC and Alberta  
Technology, composting alternatives, fly ash for road building material

#### **Air, Water, Soil and Biomonitoring**

Groundwater monitoring  
Soil monitoring  
Vegetation, lichen, and agricultural field biomonitoring  
Establishment of biomonitoring plots complete with FCIR and Air Photo interpretation  
Indoor air quality monitoring

#### **Environmental Systems Development**

Landfill design and development  
Establishment of bioremediation, composting, and recycling facilities  
Environmental training module and delivery  
Environmental procedures manual for North American Construction Group  
EUB waste module manual and delivery  
Northern Alberta compost brochure and manual  
Building operator training program waste module  
Habitat restoration and environmental aspects of linear development  
Fisheries training (linear development)  
Cleanup of upstream oilfield sites for World Bank Russia training program  
Training for Alberta Onsite Waste Water training program  
Waste management system development  
Waste module for downstream oilfield operations in Venezuela  
Waste audit report on waste resource management at Northlands Park  
Management of animal bedding from a race track by diversion from landfill and use in composting or incorporation into farm fields  
Compost marketing study for the University of Alberta  
Sewage field testing  
Intensive livestock composting seminar for the County of Lamont  
Assessment of waste dewatering market for Western Canada  
Waste audit and waste minimization implementation  
Development of integrated waste management facility for Fero, Yukon  
Environmental management course, waste management, construction, and operations for Russia  
World Bank  
Development of waste management facility for Margao, India  
International hazardous waste management pricing survey  
Operational enhancement of community septic system and design of new infiltration field  
Establishment of hazardous waste transfer station, including market analysis  
Assistance in establishing bioremediation market  
Assistance and rewrite of production unit subscription and business plan  
Assistance on CADR grinding technology  
Assessment of proposals for PCB regulatory framework for Colombia  
Historical environmental review for Paintearth Resource Recovery Centre, Coronation, Alberta  
Energy management plan  
Development of micropower interconnection on-line manual  
Installation of monitoring and demonstration system for solar heating project

#### **Applications, Licenses, and Regulatory Assistance**

Facility approval applications  
Integrated municipal waste facility Board of Health application  
Industrial application for waste handling facilities  
Waste management applications



AEUB Guide 58 applications  
AEUB Guide 55 support  
Water well application for facility water supply system  
Redefinition of hazardous waste for Canadian Environmental Protection Act  
Assessment of regulations for importation of hauling waste from other countries  
Development of the Medicine Hat Waste Management Facility, Petro-Canada  
Development of the Paintearth Resource Recovery Centre  
Development of commercial land for Wetaskiwin, Alberta